

T.8S. R. 39E. W.M.

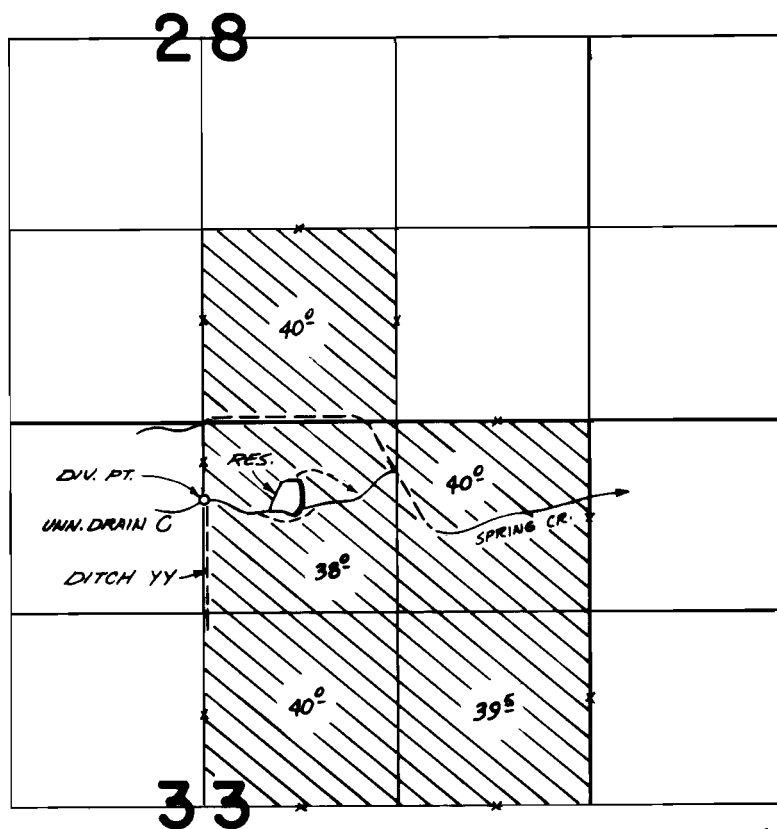

DIV. PT. LOCATED 540' S. & 5' E.; COLLECTION DITCH YY
 LOCATED BETWEEN POINTS 540' S. & 5' E. & 1450' S. & 5' E.
 RES. LOCATED 600' S. & 680' E.
 ALL FROM THE N. 1/4 COR. SEC. 33.

FINAL PROOF SURVEY UNDER

Application No. 51953 R52240 Permit No. 39079 R6259
 IN NAME OF

NORMAN BUTLER

Surveyed JUNE 19 1976, by G.R. KING