

T.28&29S. R.14&15W. W.M.

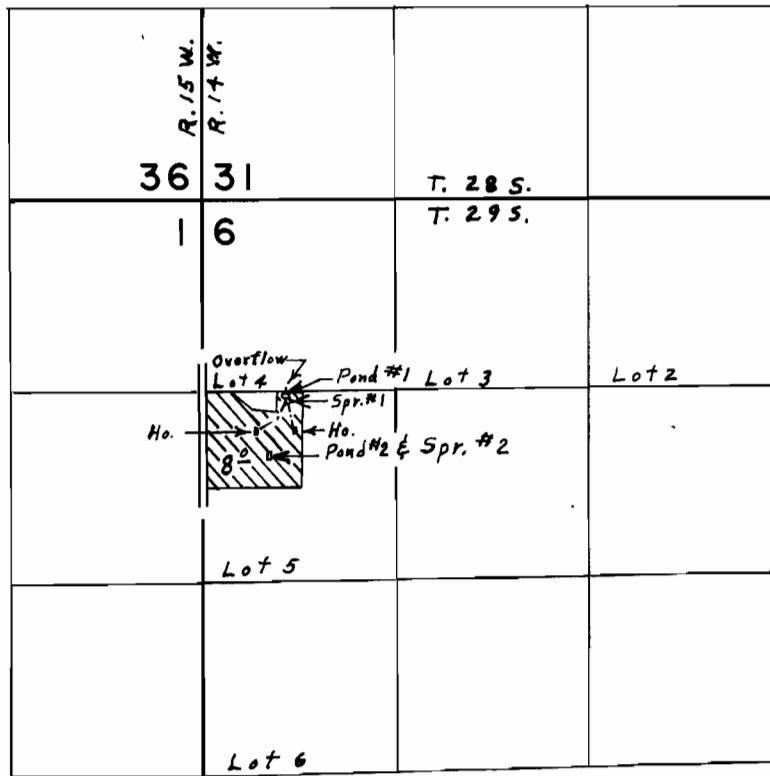

Springs located; #1, 1380' S. & 580' E.; #2, 1770' S.
& 450' E. from N.W. Cor. Sec. 6

FINAL PROOF SURVEY UNDER

Application No. 48761 R-51811 Permit No. 36571 R-6264
51812 39141

IN NAME OF

OSCAR C. & GOLDA K. PATRIDGE

Surveyed July 20, 1976, by L. E. Gould