

T.26S. R.5W. W.M.

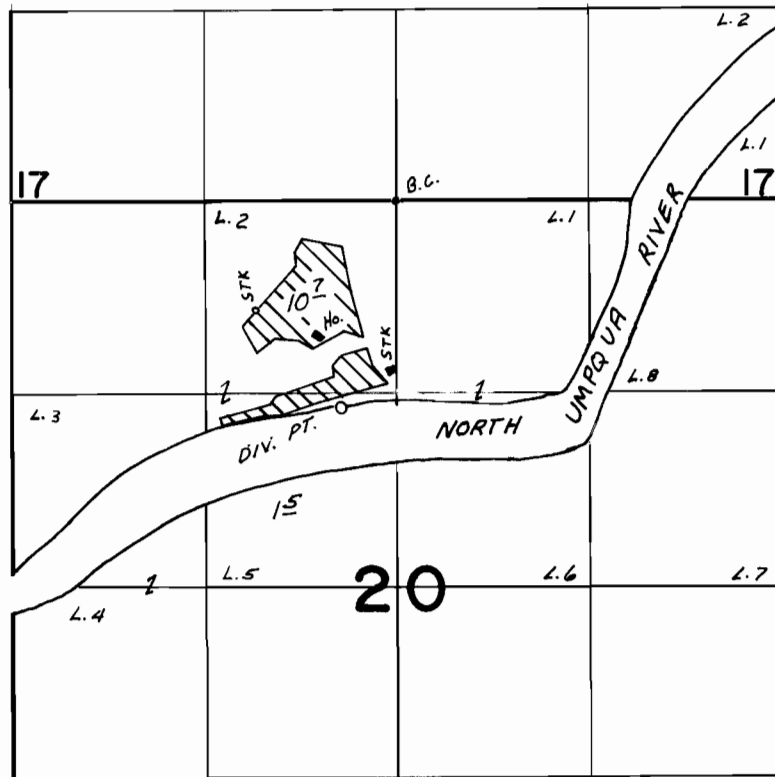

DIV. PT. LOC. 1410'S. & 380'W. FROM N 1/4 COR. SEC. 20

FINAL PROOF SURVEY
UNDER

Application No. 49731 Permit No. 37243
IN NAME OF
ESTATE OF STANLEY I. & STANLEY E. SHORT
& MARY EUGENIA SHORT

Surveyed OCT. 5 1976, by L.H. NUNN