

# T.26S., R.4W., W.M.

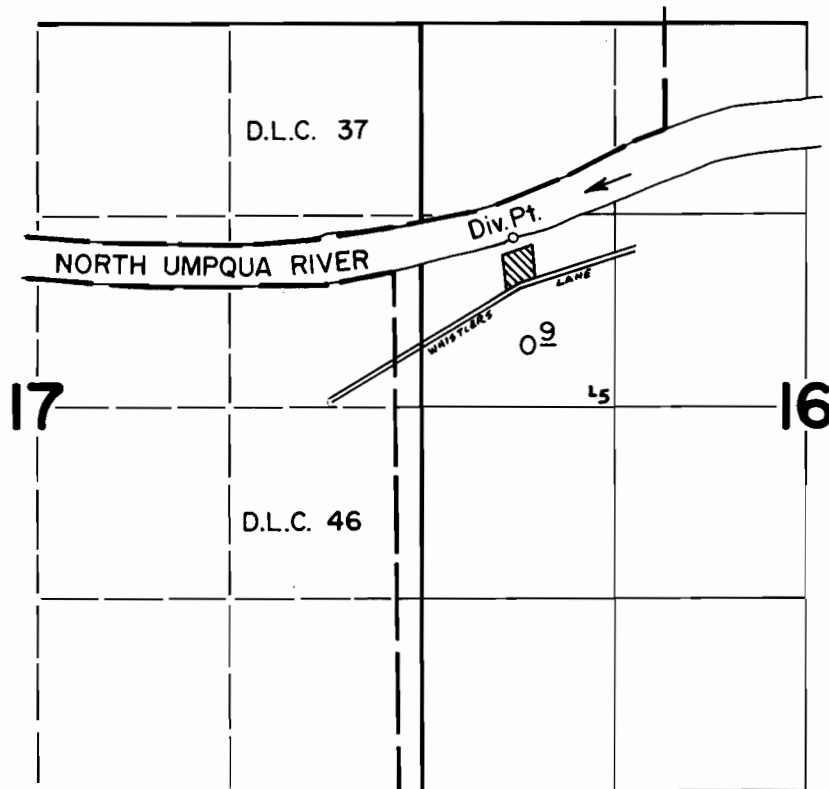

DIV. PT. LOC: 1470' S & 630' E FROM NW COR. SEC. 16

## FINAL PROOF SURVEY UNDER

Application No. 51010 Permit No. 38503  
IN NAME OF

ELWIN L. CHURCH

Surveyed April 6, 1976, by D. Norby