

T.24S., R.3W., W.M.

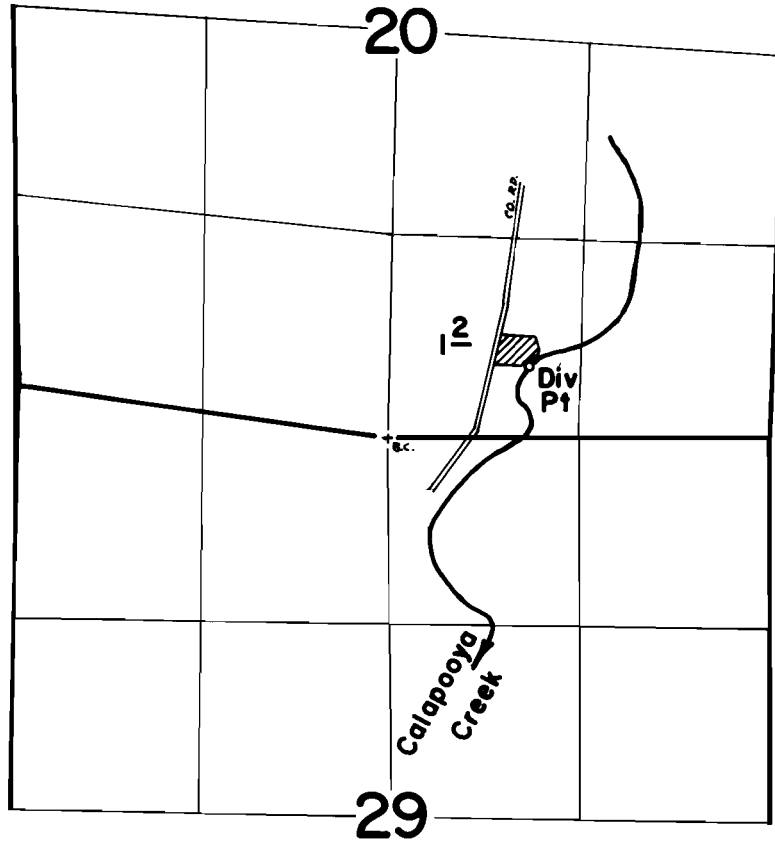

DIV. PT. LOC: 490' N & 960' E FROM S 1/4 COR. SEC. 20

FINAL PROOF SURVEY
UNDER

Application No. 51592 Permit No. 38915
IN NAME OF

HOWARD A. & THELMA N. ELDER

Surveyed July 29 1976, by D. Norby