

T.22S.R.5W.W.M.

SECTION 31

1" = 660'

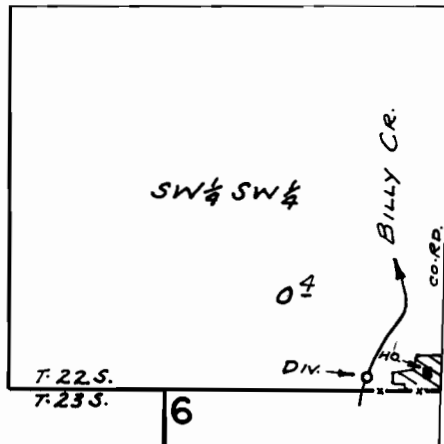

Div. Loc: 40' N. & 270' W. FROM S.E. COR. SW 1/4 SW 1/4 SEC. 31

FINAL PROOF SURVEY UNDER

Application No. 51879... Permit No. 39050.
IN NAME OF

JAMES W. & MABEL L. NELSON

Surveyed MAY 24, 1976., by R. MUCKEN