

# T.22S.R.5W.W.M.

SECTION 31

1" = 660'

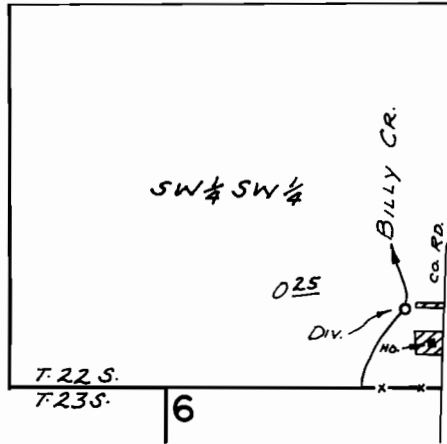

Div. Loc: 150' W. & 270' N. FROM SE. COR. SW 1/4 SW 1/4 SEC. 31

## FINAL PROOF SURVEY UNDER

Application No. 51895 Permit No. 39056  
IN NAME OF

MARION & MARY M. BALDWIN

Surveyed MAY 24, 1976, by R. MUCKEN