

# T.22S.R.4W.W.M.

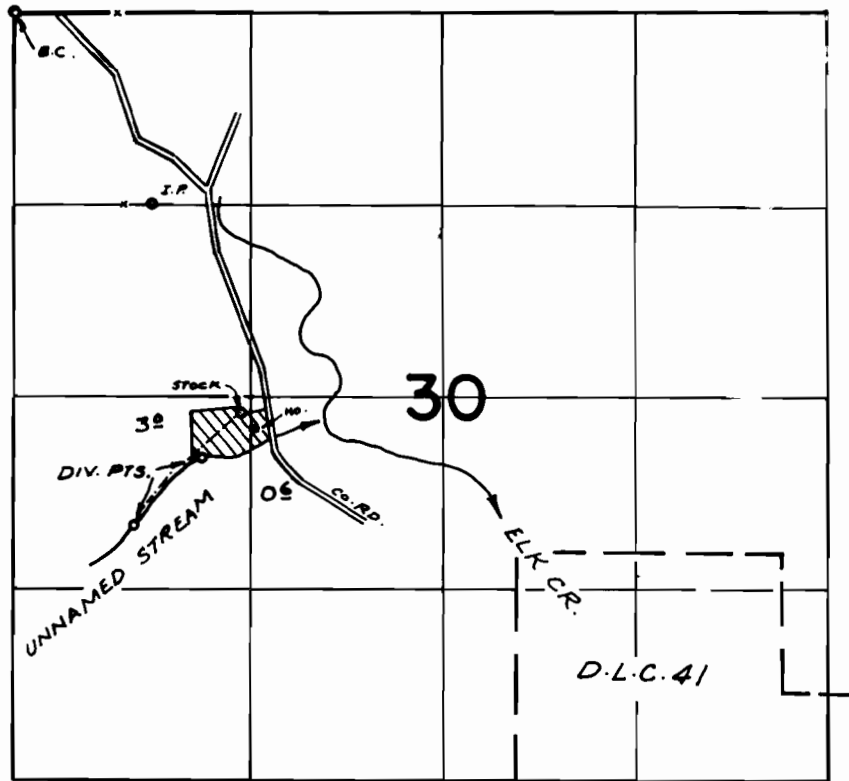

DIV. PTS. Loc: 3070'S. & 1300'E.; 3530'S. & 820'E., BOTH FROM N.W. COR. SEC. 30

## FINAL PROOF SURVEY UNDER

Application No. 50127 Permit No. 37665  
IN NAME OF

GEORGE BARTLETT

Surveyed MAY 25, 1976, by R. MUCKEN