

**RECEIVED**

JAN 31 2001

WATER RESOURCES DEPT.  
SALEM, OREGON

**T.1S. R.4E. W.M.**

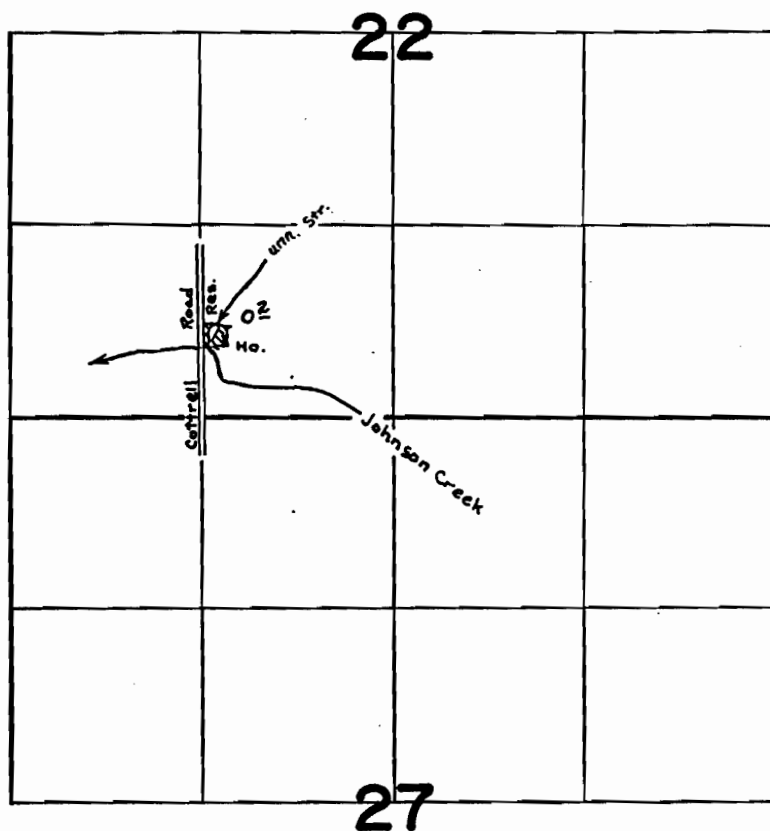

Res. Located : 500' N  $\frac{1}{2}$  1250' W from S  $\frac{1}{4}$  cor. Sec. 22

**FINAL PROOF SURVEY**  
UNDER

R-47516                      R-5859  
Application No. 47753    Permit No. 36170  
IN NAME OF

GRANT E. STURM

Surveyed AUG. 11, 1976., by L.E. GOULD