

T. 6 S. R. 7 W. W. M.

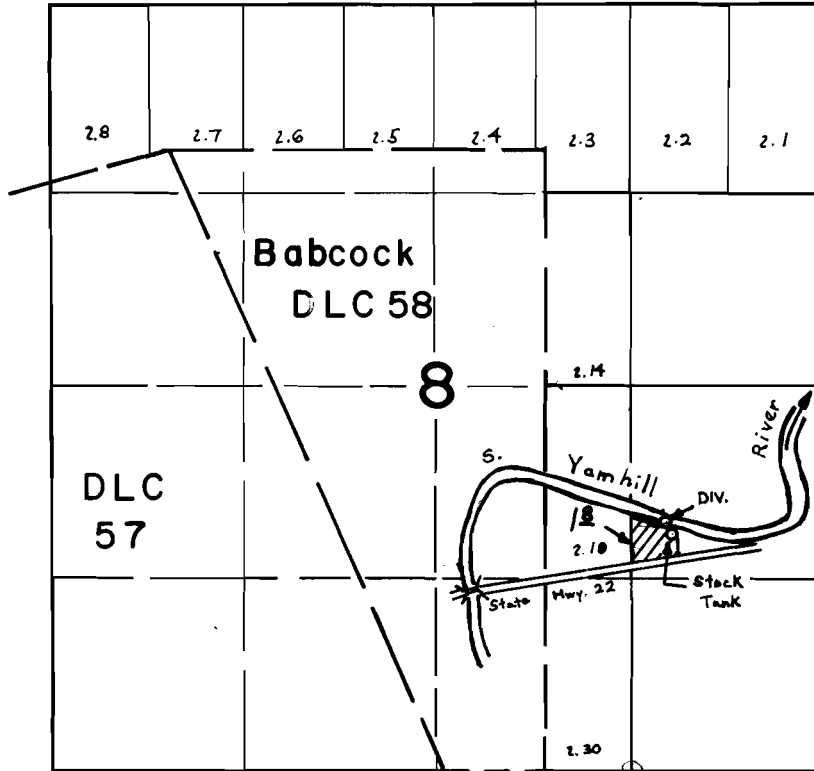

DIV. LOC. - 1720' N. & 240' E. FROM S.W. COR. S.E. 1/4 S.E. 1/4

FINAL PROOF SURVEY
UNDER

Application No. 53140 Permit No. 38774

IN NAME OF

Betty B Reid

Surveyed June 8, 1976, by R. G. Mucken