

T.1N. R.3W. W.M.

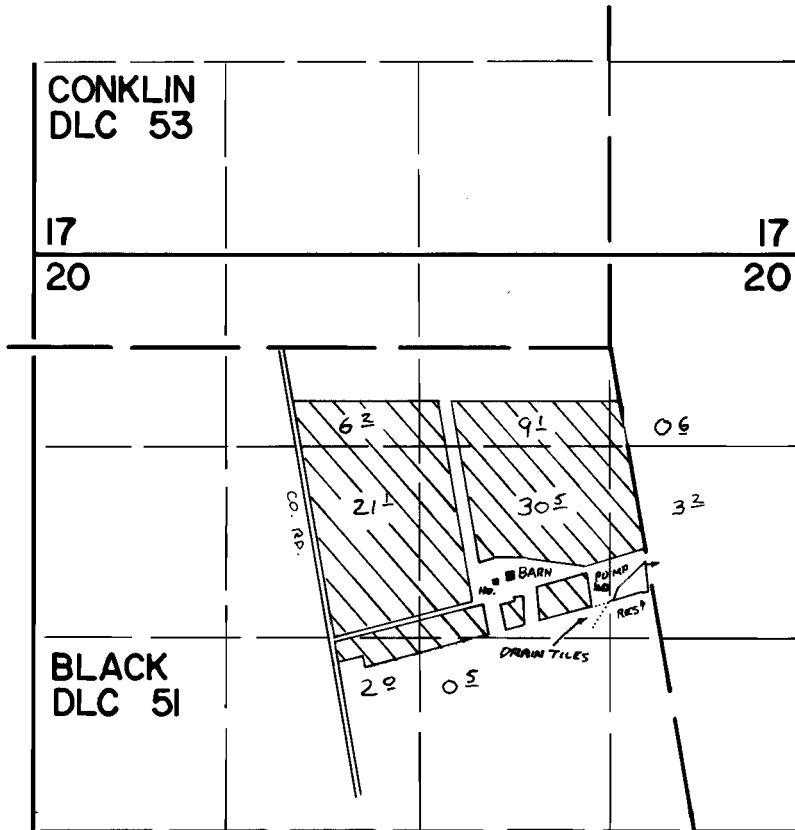

DAM LOCATED 500' N & 270' E FROM THE SE COR SW 1/4 NE 1/4 SEC 20

FINAL PROOF SURVEY UNDER

R-50372 R-6147
 Application No. 50373 Permit No. 38022
 IN NAME OF

OREGON ROSES, INC.

Surveyed SEPT. 27 1976, by L. E. GOULD