

T.1N. R.3W. W.M.

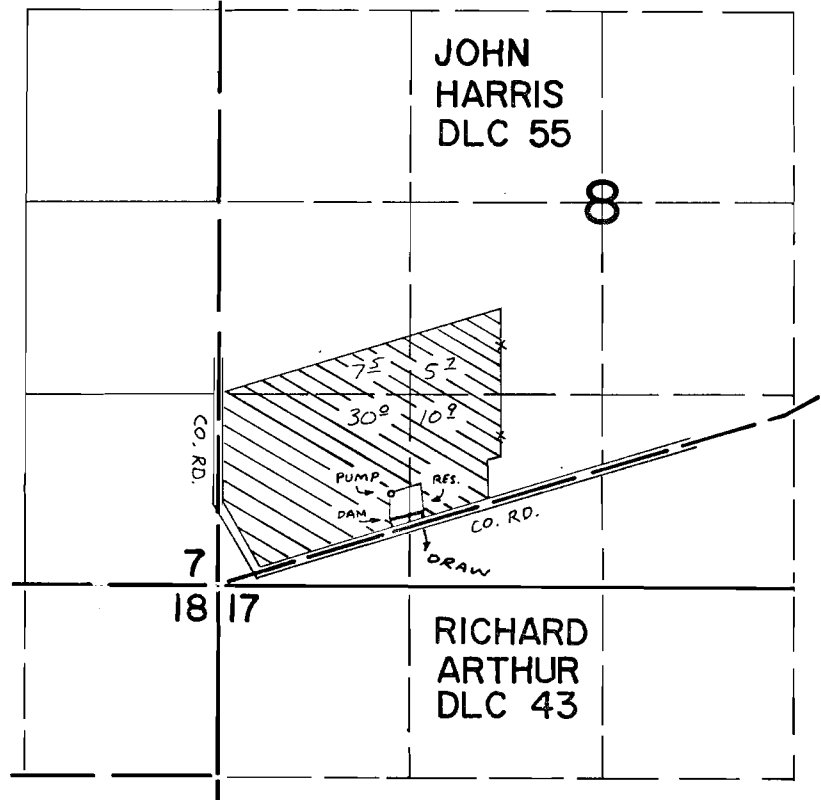

DAM LOCATED - 500' N & 1500' E FROM THE SW COR HARRIS DLC

**FINAL PROOF SURVEY**  
UNDER

R-51375 R-6233  
Application No. 51376 Permit No. 38822.....  
IN NAME OF

.....**WILFRED A. PETERS**.....

Surveyed SEPT. 29 1976., by L.E. GOULD.....