

T. 30 S. R. 46 E. W. M.

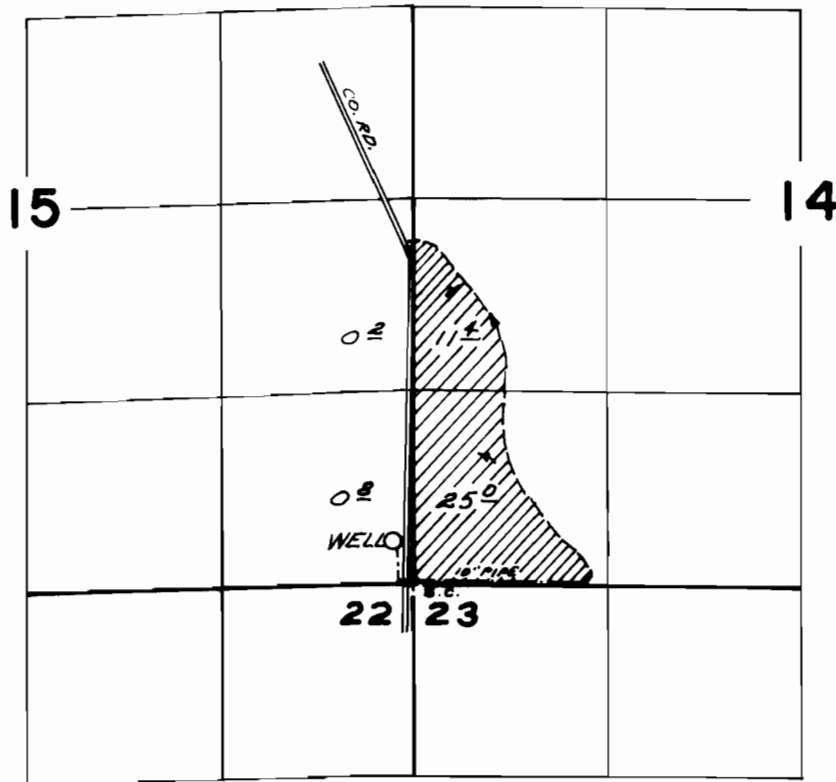

WELL LOC. : 300' N. AND 140' W FROM SE COR.
SEC. 15

FINAL PROOF SURVEY
UNDER

Application No. G-6007 Permit No. G-5675
IN NAME OF

JACA BROTHERS

Surveyed JUN 12 1976, by L. E. GOULD