

G-6120

45821

T6N R34E W.M.
Section 27

Well: source of water
to be used for irrigation

MAP to accompany
Application in Name of
Duane Lembach



1" = 1000'

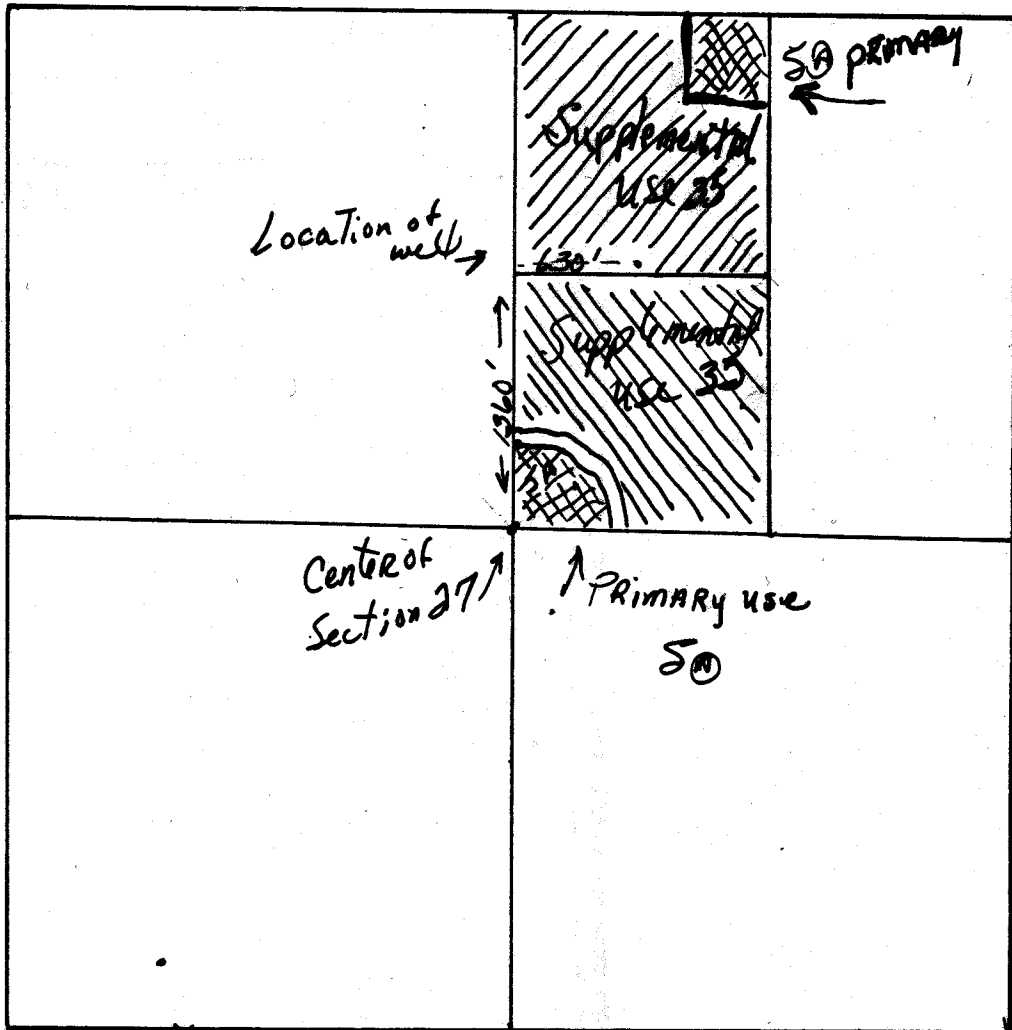

RECEIVED

OCT 22 1974
STATE ENGINEER
SALEM, OREGON

Application No. ^{NA}

H-6507

Permit No.

G 6120