

G-6519  
45826

# T. 2N. R. 33E. W.M.

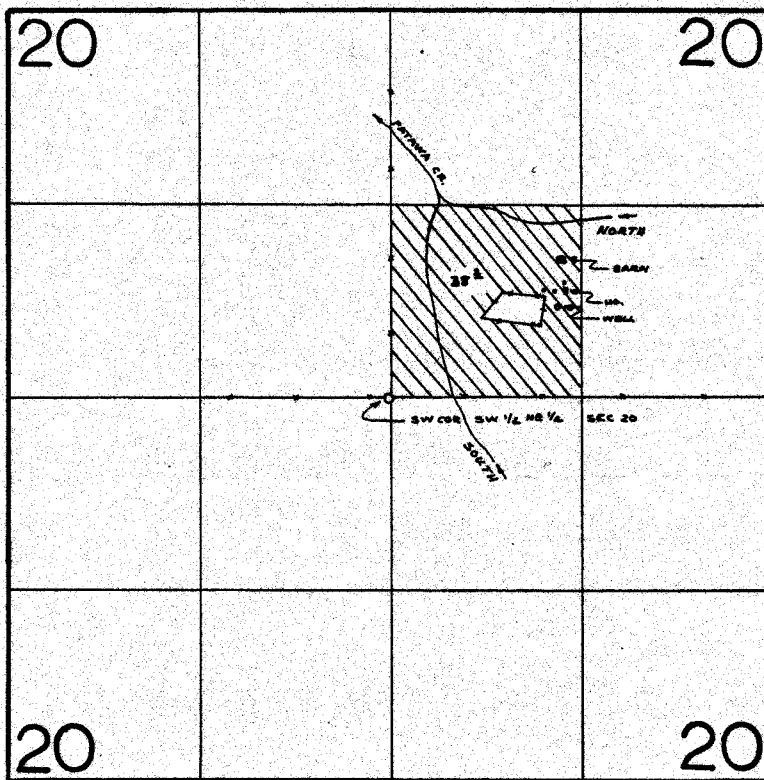

WELL LOCATED 600' N. & 1140' E. FROM SW COR SW 1/4 NE 1/4 SEC 20

## FINAL PROOF SURVEY UNDER

Application No. G 7028 Permit No. G 6519  
IN NAME OF

CIMMIYOTTI'S PROPERTY INC.

Surveyed SEPT 29 1977 by R. BARWIN