

T.2N.,R.31E.,W.M.

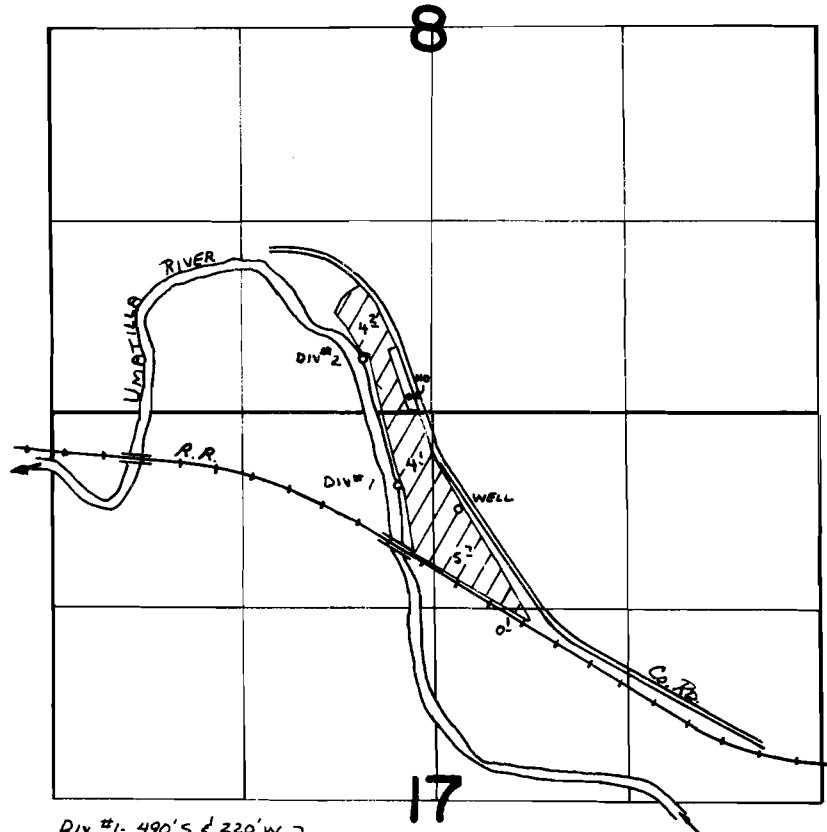

DIV #1- 490' S & 220' W }
DIV #2- 380' N & 470' W } FROM S 1/4 COR SEC 8
WELL - 660' S & 180' E }

FINAL PROOF SURVEY
UNDER

Application No. **45513** Permit No. **33966**
~~G-4676~~ ~~G-4404~~
IN NAME OF

.....**MARVIN G. DALLMAN**.....

Surveyed **APRIL 3** 19**75**, by **L. Toll**.....