

T.27S. R.7W. W.M

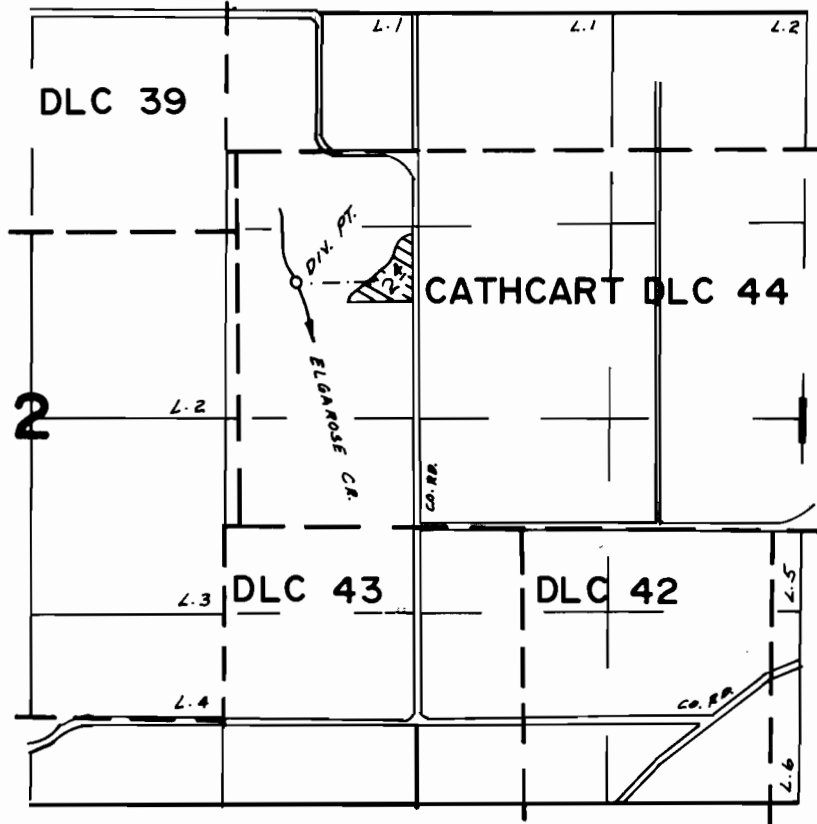

DIV. PT. LOC. 1850'S & 800'W FROM NE COR. SEC. 2

FINAL PROOF SURVEY
UNDER

Application No. 52526... Permit No. 39642...
IN NAME OF

.....WOODROW W. MILLER.....

Surveyed SEP. 30. 1976., by L.H. NUNN.....