

SECTION 17 T37S R.6W W.M.
JOSEPHINE COUNTY

1" = 400'

RECEIVED

FEB 7 1974

STATE ENGINEER
SALEM, OREGON

8 9

17 16

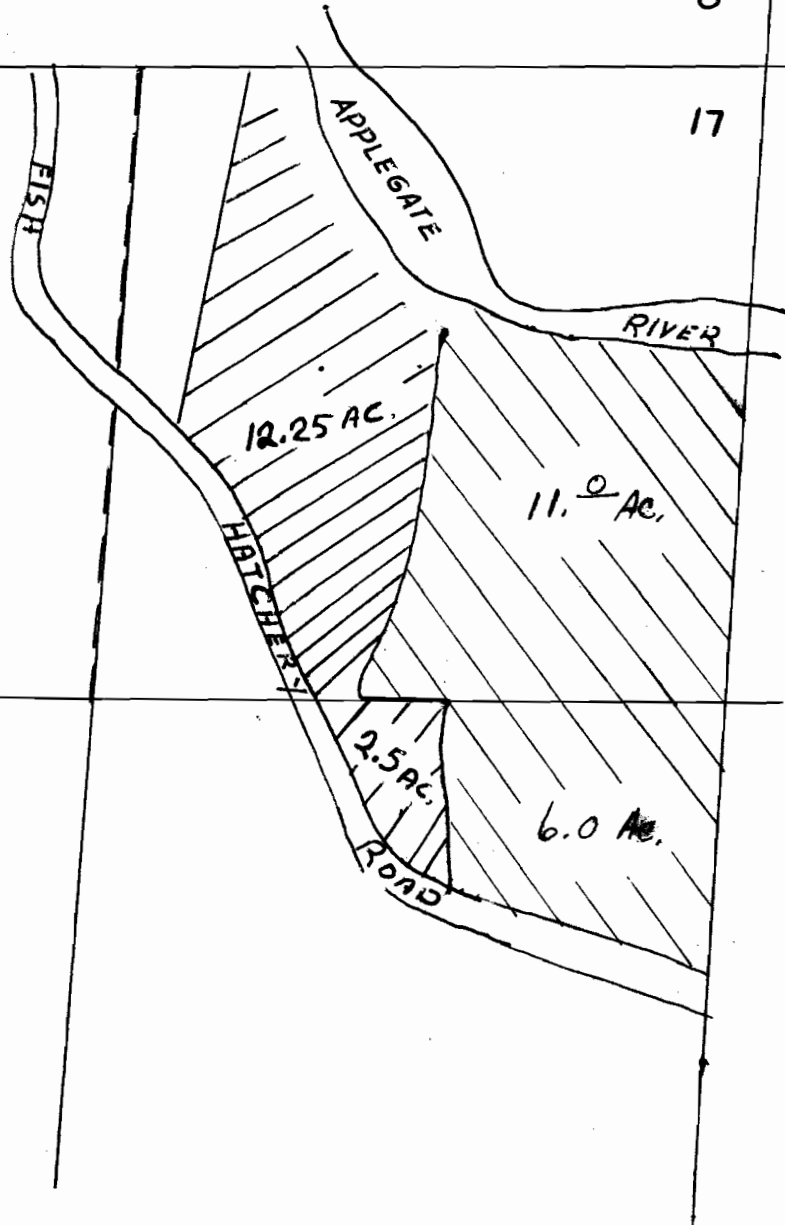

RECEIVED
MAY 6 1974
STATE ENGINEER
SALEM, OREGON

 Per. 4135

 New App.

Application No. 51649
Permit .38946