

T.1N. R.3E. W.M.

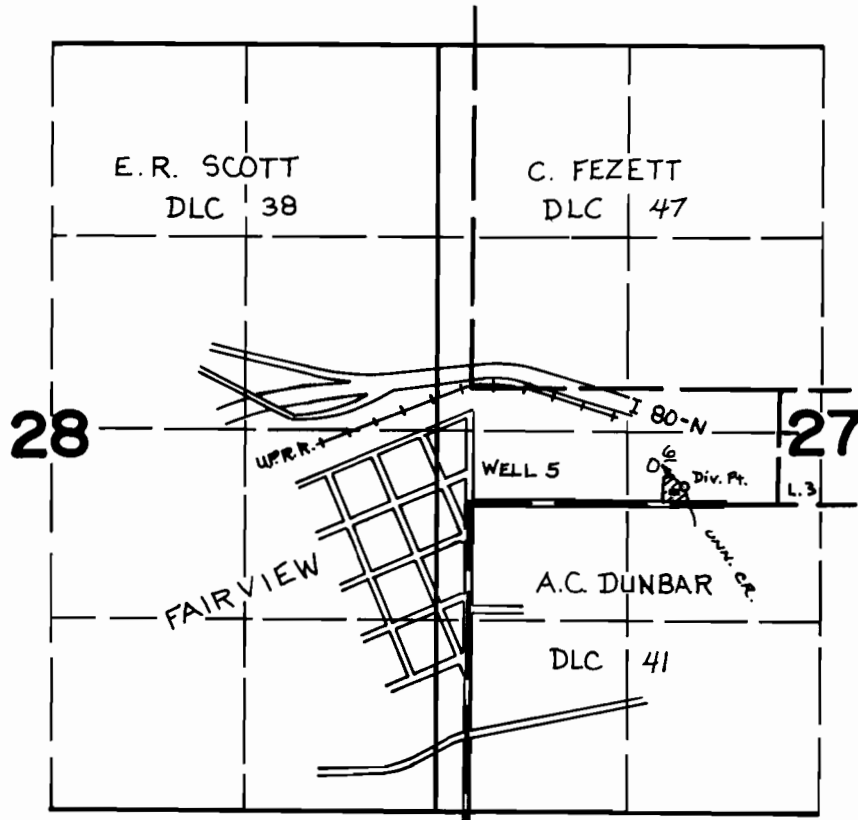

Div. Pt. Located 375'S & 950'W from C 1/4 cor. Sec 27

FINAL PROOF SURVEY UNDER

Application No. 48696. Permit No. 36510.
IN NAME OF

.....ROBERT G. ZIMMERMAN.....

Surveyed AUG. 12, 1976., by L.E. GOULD.....