

T.9S.,R.5W.,W.M.

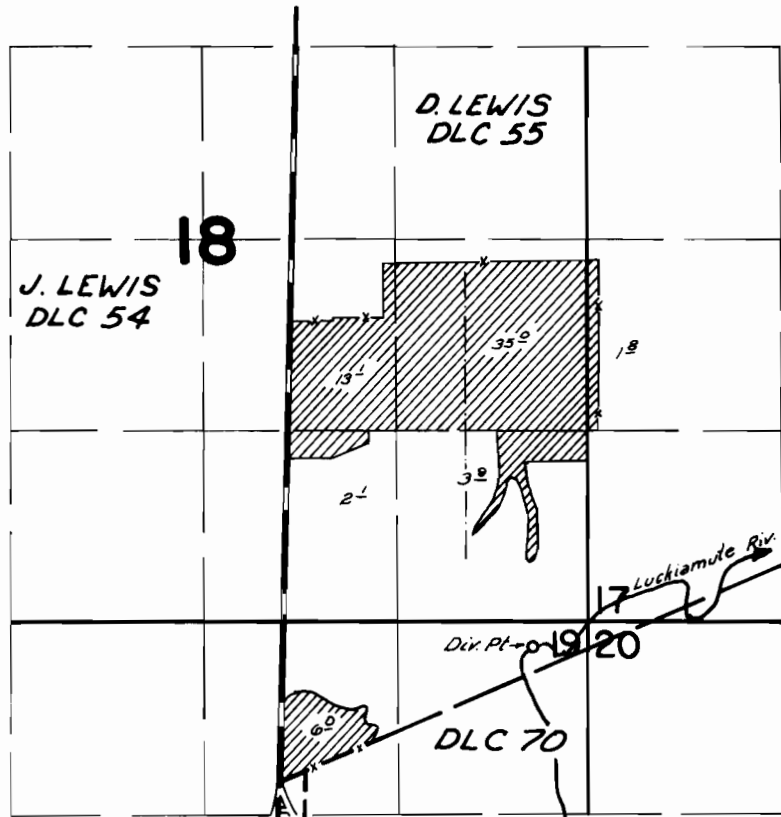

Dir. Pt. Loc.: 910' N. & 1700' E. from SW Cor. DLC 55

FINAL PROOF SURVEY UNDER

Application No. 49595 Permit No. 37216
IN NAME OF

Herman D. Johnson

Surveyed July 8, 1976 by C.R. King