

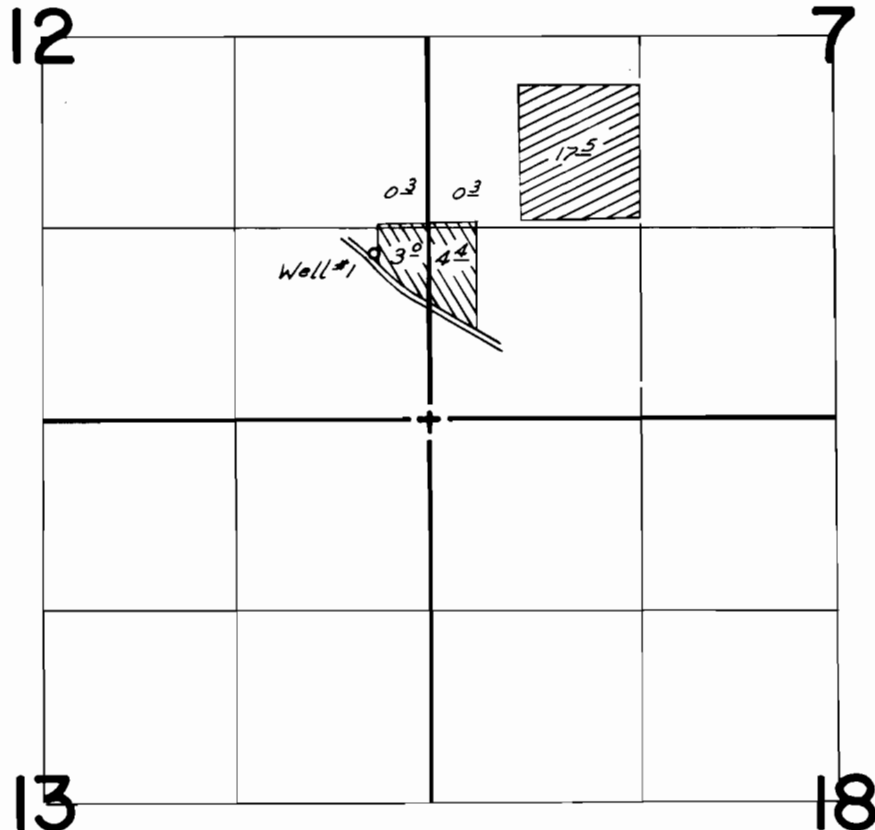

T.4S.,R.1E.,&R.1W.,W.M.



Well #1 Loc.: 1140' N. & 370' W. from SW Cor. Sec. 7

 Primary
Suppl.

FINAL PROOF SURVEY UNDER

Application No. G-7000 Permit No. G-6502
IN NAME OF

Weyerhaeuser Co.

Surveyed July 29 1977, by AC Brown