

# T.4S.,R.1E.,&R.1W.,W.M.

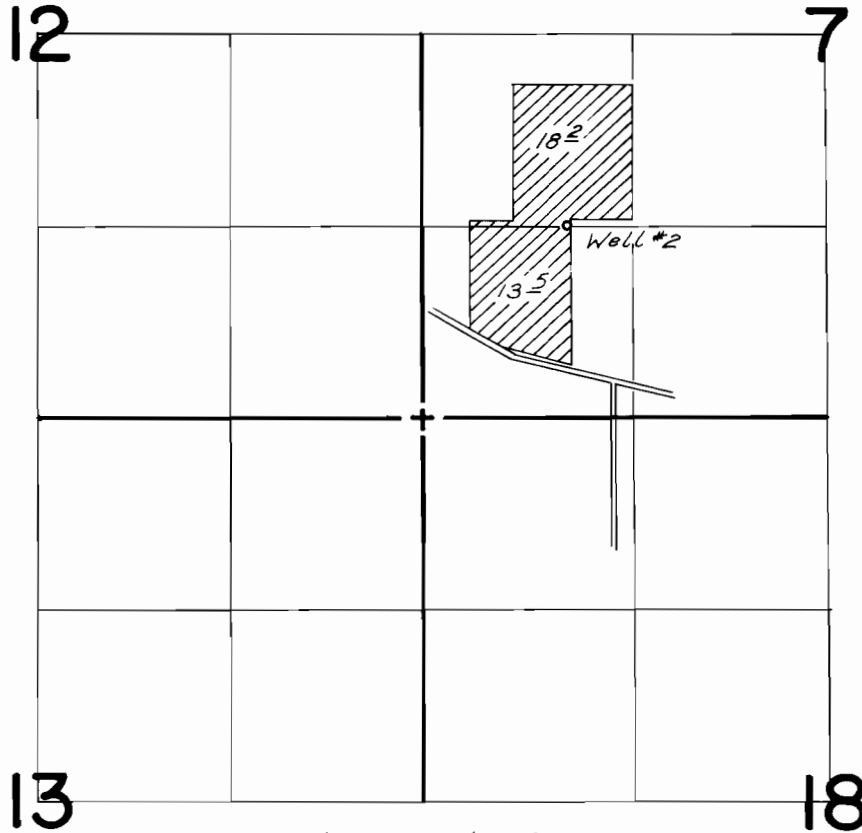

Well #2 Loc.: 1340' N. & 1020' E. from SW Cor. Sec. 7

## FINAL PROOF SURVEY UNDER

Application No. G-7701 Permit No. G-6503  
IN NAME OF

Weyerhaeuser Co.

Surveyed July 29, 1977, by AC Brown