

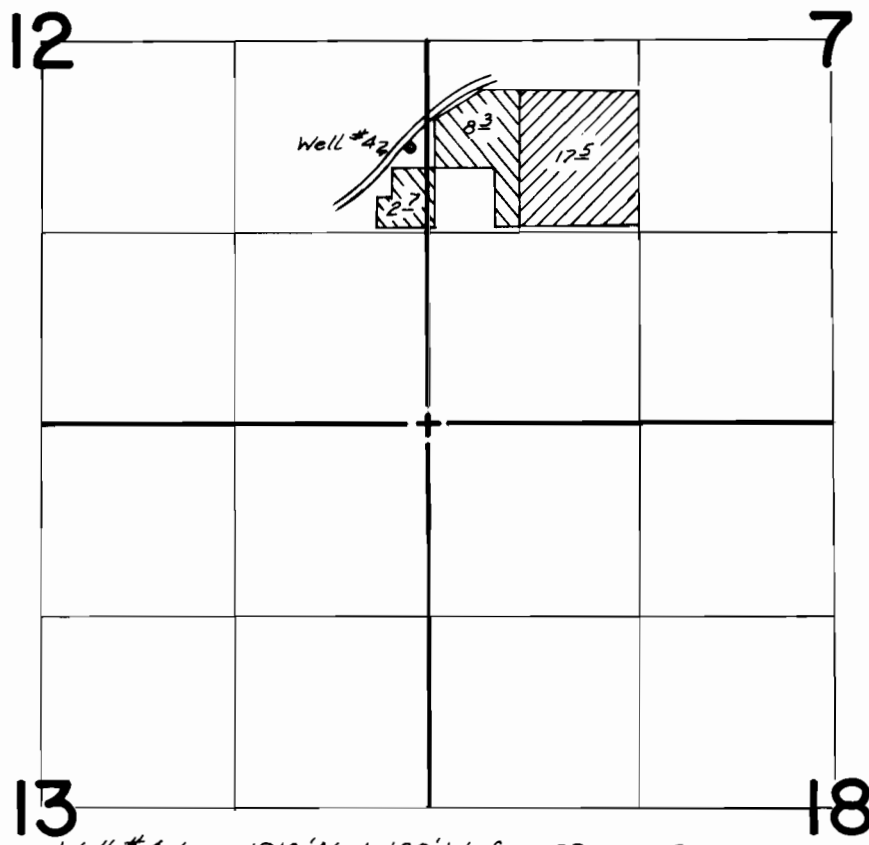

T.4S.,R.1E.,&R.1W.,W.M.



Well #4 Loc.: 1910' N. & 120' W. from SE cor. Sec. 12

 Primary
 Suppl.

FINAL PROOF SURVEY UNDER

Application No. G-7003 Permit No. G-6505
IN NAME OF

Weyerhaeuser Co.

Surveyed July 29, 1977 by J.C. Brown