

T.27S., R.5W., W.M.

DRAFTED APPROX 30' TOO FAR E.
CHING TO INSP.
R.C.M.

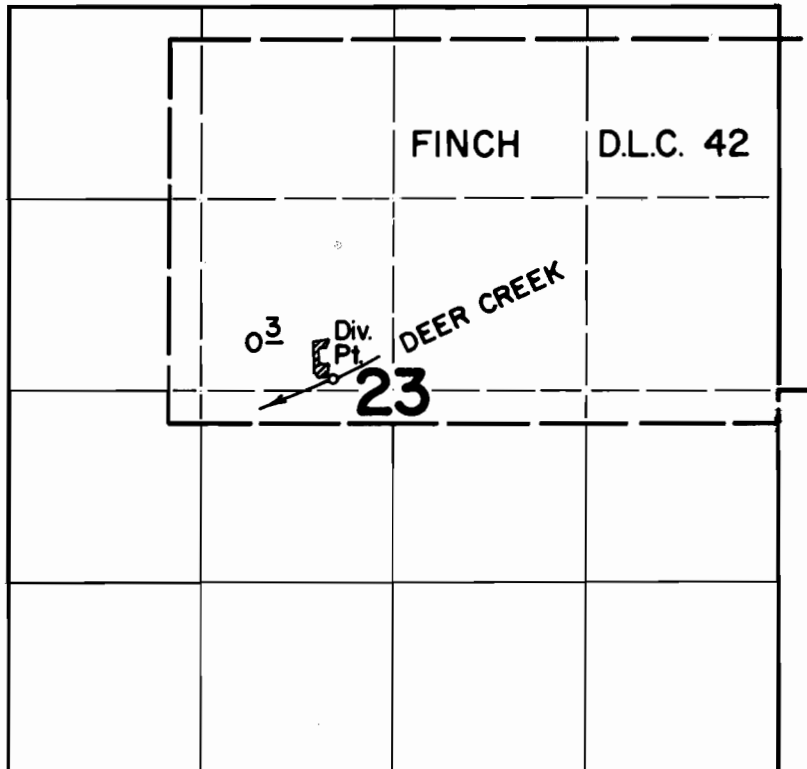

DIV. PT. LOC: 80' N & 3060' W FROM E1/4 COR. SEC. 23

FINAL PROOF SURVEY UNDER

Application No. 50384 Permit No. 38029
IN NAME OF

GEORGE W. JAMES, JR.

Surveyed April 5 1976, by D. Norby