

T.26S. R.7W. W.M.

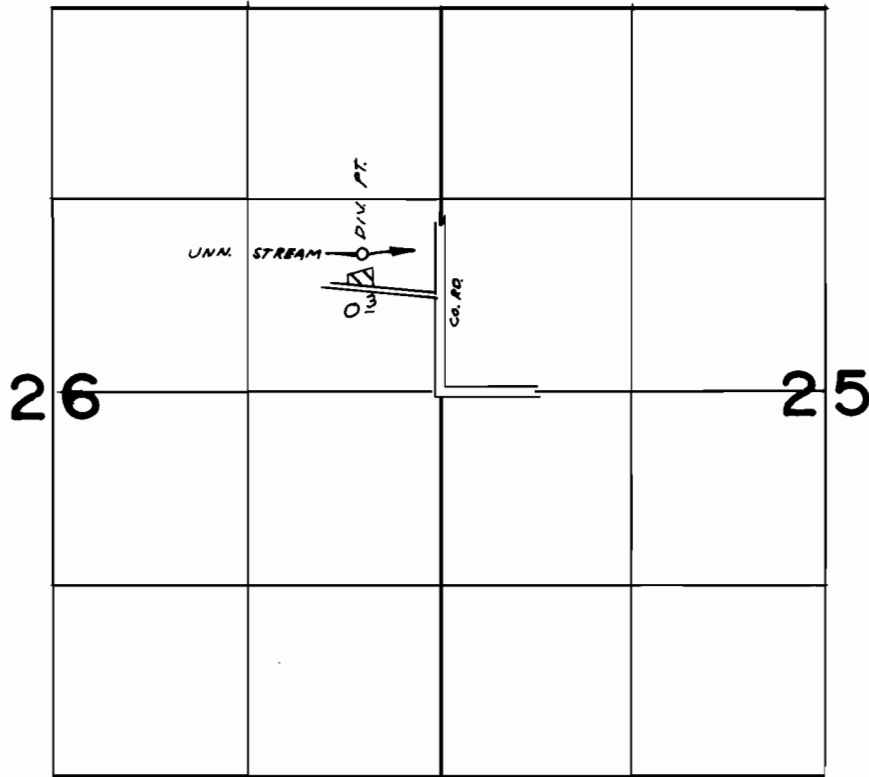

DIV. PT. LOC. 950' N. & 540' W. FROM E 1/4 COR. SEC. 26.

**FINAL PROOF SURVEY**  
UNDER

Application No. 50846... Permit No. 38390...  
IN NAME OF

.....BURTON W. SARGENT.....

Surveyed APR...8... 1976., by L.H. NUNN.....