

T.14S. R.39E. W.M.

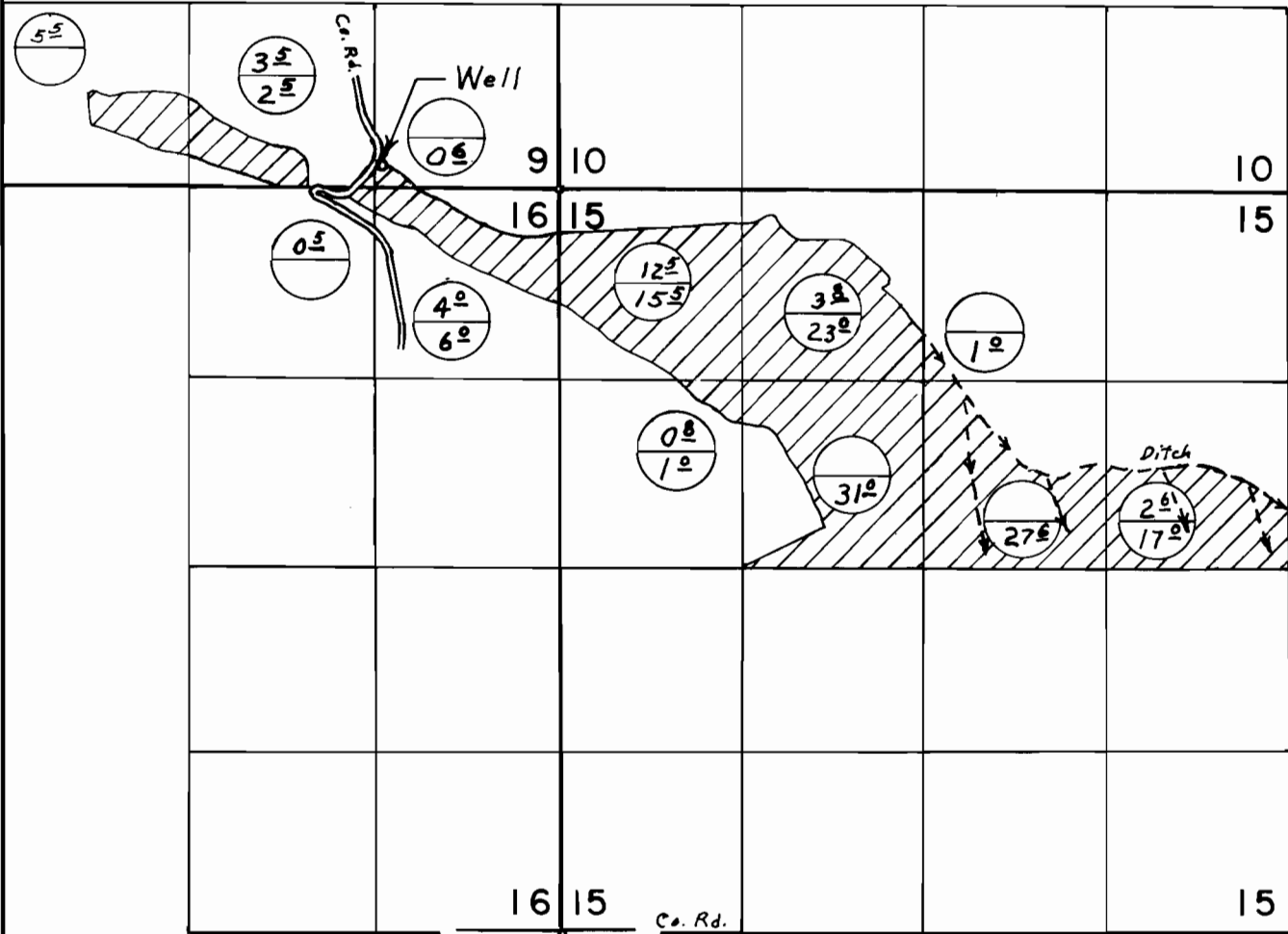

Well located 150' N. & 1270' W. from S.E. Corner Section 9

Primary
Supplemental



FINAL PROOF SURVEY UNDER

Application No. G-6304 Permit No. G-5926
IN NAME OF

CHARLES McCOY

Surveyed April 28, 1976, by L. E. Gould