

T.8S., R.4W., W.M.

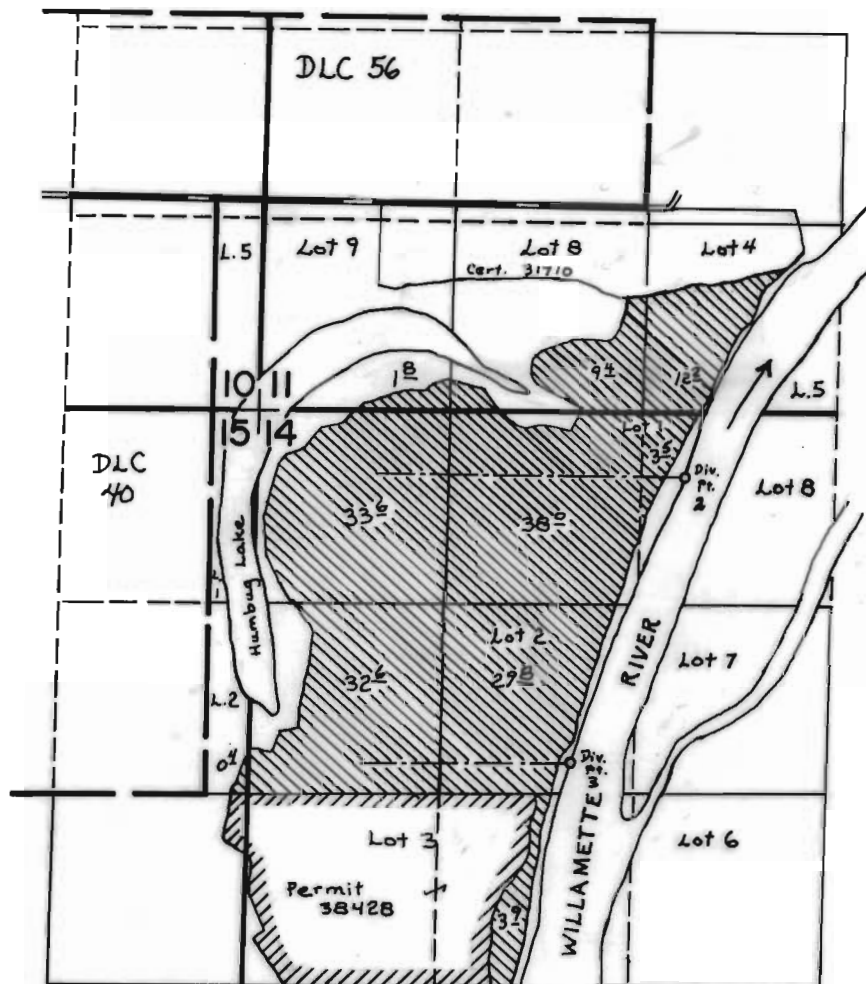

Div. Pts Located: 2- 440'S ± 300'E; 3- 2420'S ± 440'W' from the N 1/4 Cor. Sec. 14

FINAL PROOF SURVEY UNDER

Application No. 50950 Permit No. 38463
IN NAME OF

MARX FARMS INC

Surveyed MAY 18 1976, by C. KING