

T.27S., R.11W., W.M.

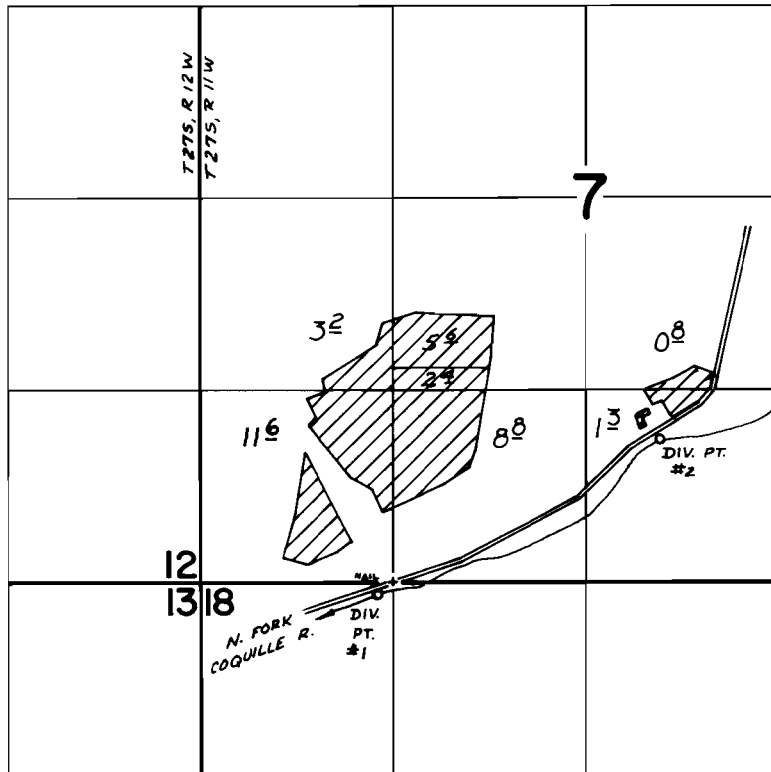

DIV. PTS. LOC: *1- 80'S & 110'W; *2- 980'N & 1830'E BOTH FROM SW COR.
SE 1/4 SW 1/4 SECTION 7.

FINAL PROOF SURVEY UNDER

Application No. 50913 Permit No. 38438
IN NAME OF

CHARLES THOMMEN

Surveyed July 15 1976, by D. Norby