

T.32S. R.4W. W.M.

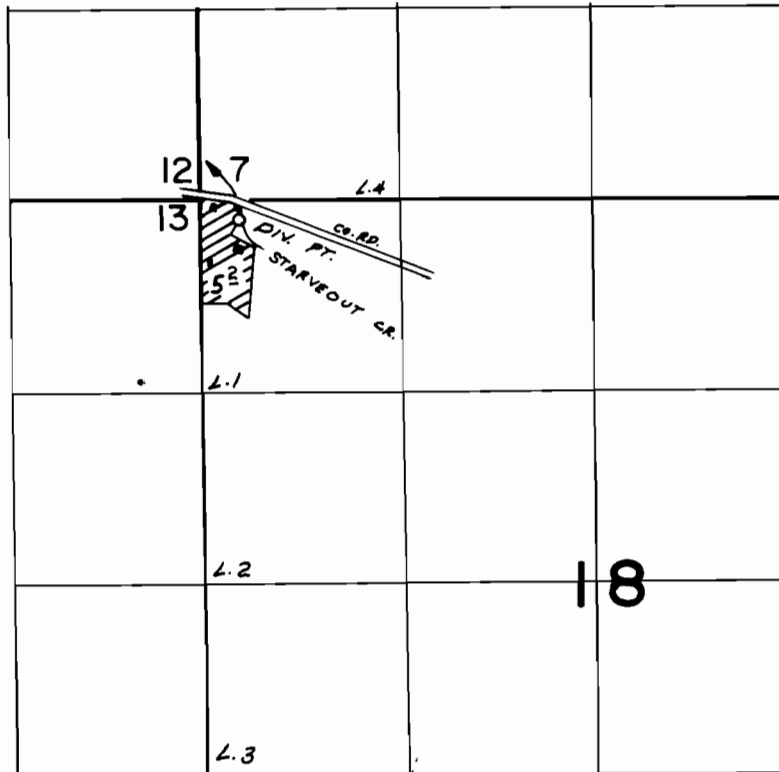

DIV. PT. LOC. 120' S. & 200' E FROM NW COR. SEC. 18.

FINAL PROOF SURVEY
UNDER

Application No. 48701..... Permit No. 36514.....
IN NAME OF

.....DELANO & DORTHEY CASTEN.....

Surveyed JUL. 14. 1976., by L.H. NUNN.....