

T. 4N. R. 37E. W.M.

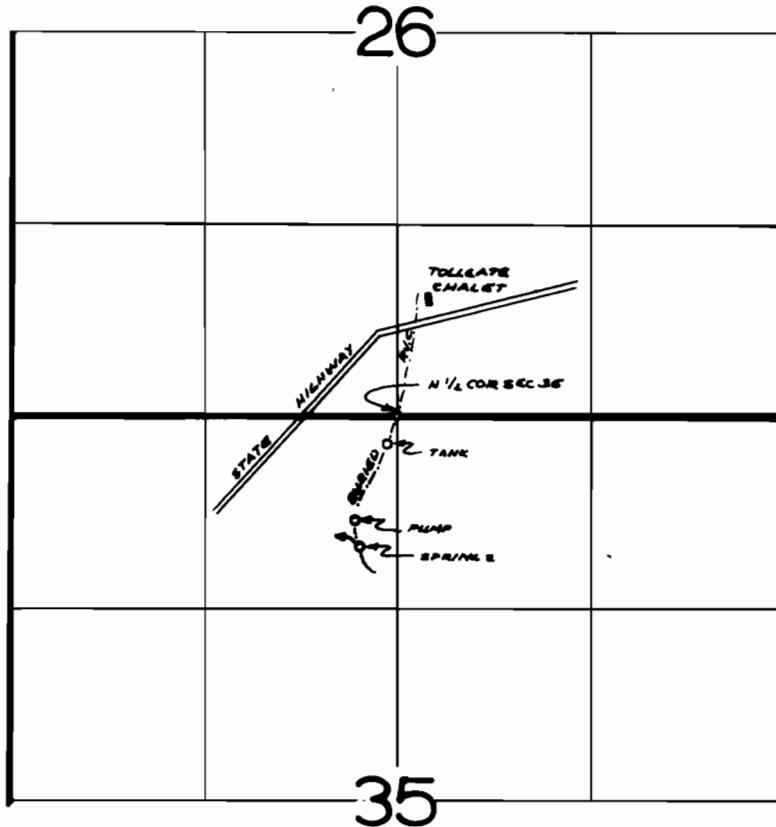

SPRING 2 LOCATED 270' W. & 870' S. FROM N 1/4 COR SEC 35

FINAL PROOF SURVEY
UNDER

Application No. 55211 Permit No. 41614
IN NAME OF

JULIUS SCOFIELD

Surveyed OCT. 14. 1977. by R. BARWIN