

~~R-40706~~

T.IN. R.IOE. W.M.

P 4576

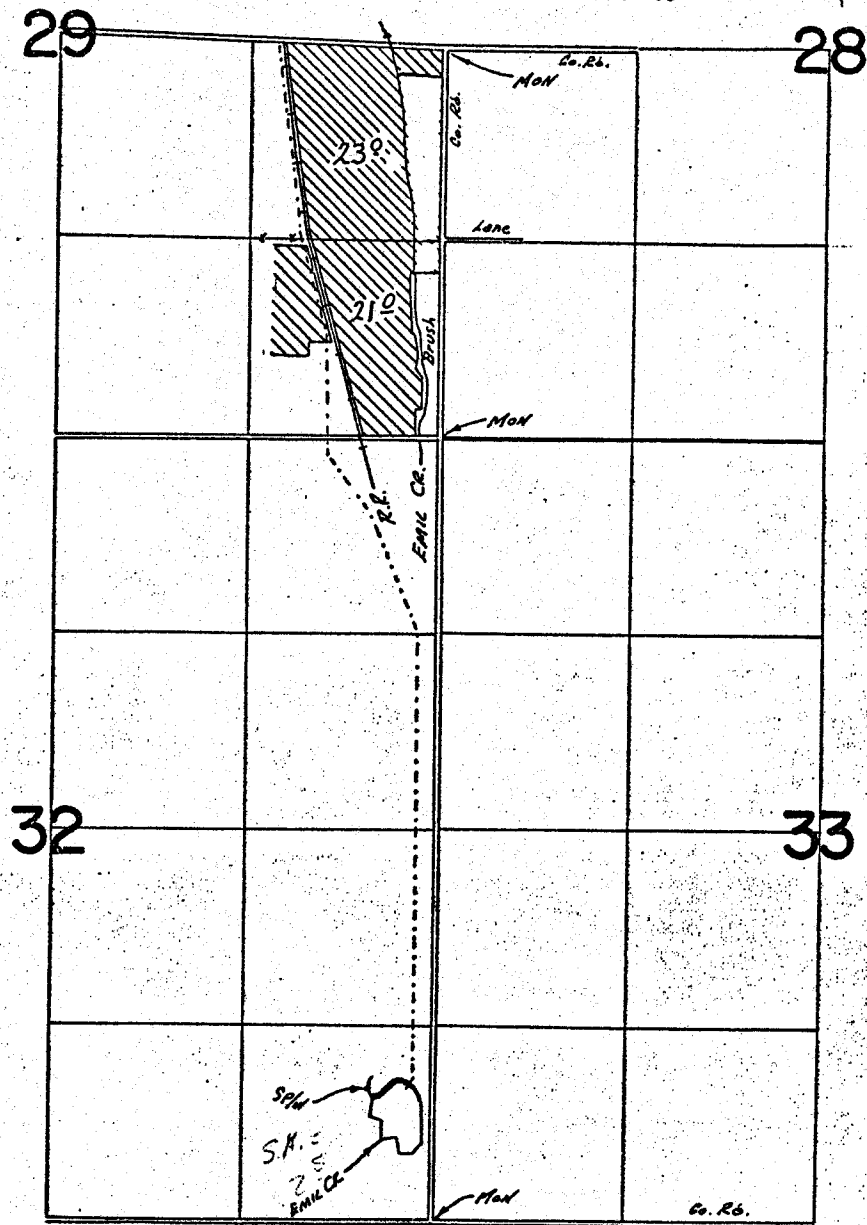

DN. LOC. 920' N. & 170' W. FROM S-E COR. SEC. 32

FINAL PROOF SURVEY UNDER

R-40706 R-4576
Application No. 40722 Permit No. 30434
IN NAME OF

MIDDLE FORK IRRIGATION DISTRICT

Surveyed June 17, 1975, by T. PAUL