

T. 15&16S., R. 5W., W.M.

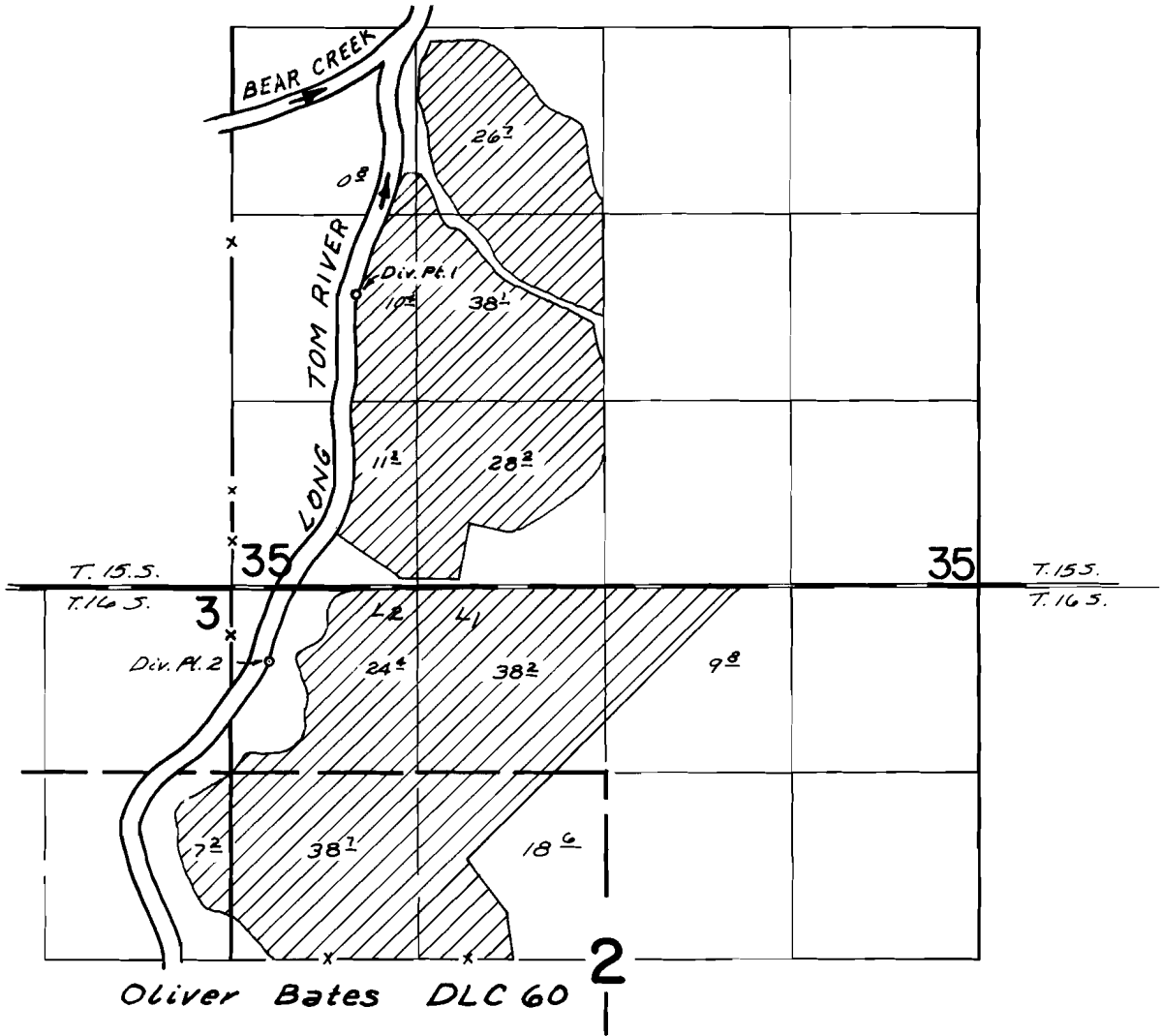

Div. Pts. Loc.: #1-2070' N & 870' E.; #2-540' S. & 250' E.,
from S.W. Cor. Sec. 35

FINAL PROOF SURVEY UNDER

Application No. 43781 Permit No. 32715
IN NAME OF

Carl S. & Patricia M. Lingo

Surveyed May 12, 1976, by D.M. Norby