

T. 16S., R. 4E., W.M.

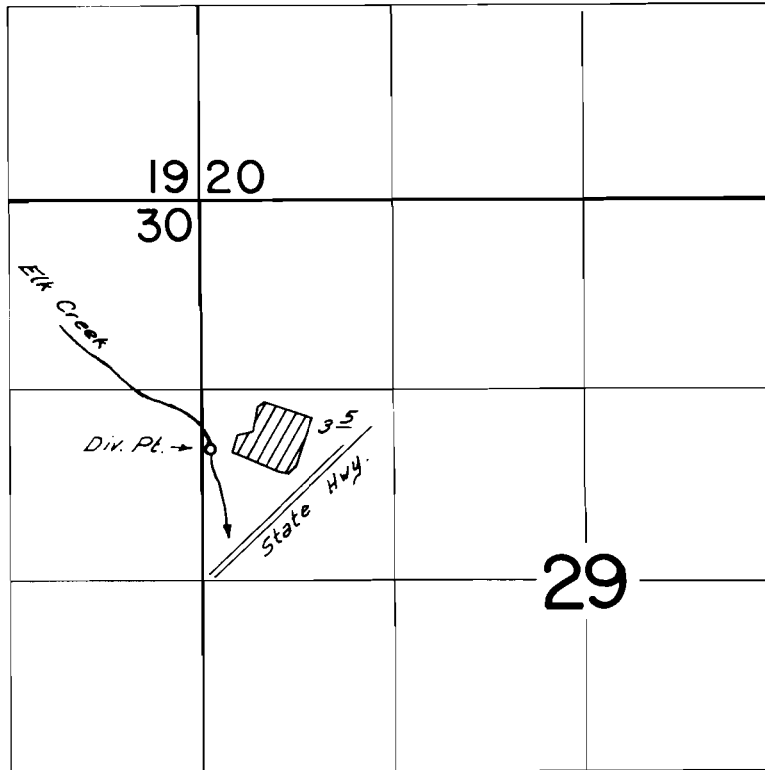

DIV. PT. LOC.: 1720 'S. of 60'E. from NW Cor. Sec 29

FINAL PROOF SURVEY UNDER

Application No. 46439 Permit No. 34698
IN NAME OF

McKenzie River Schools Dist. No. 68

Surveyed May 25 1976, by D.M. Nerby