

T.16S.,R.2E.,W.M.

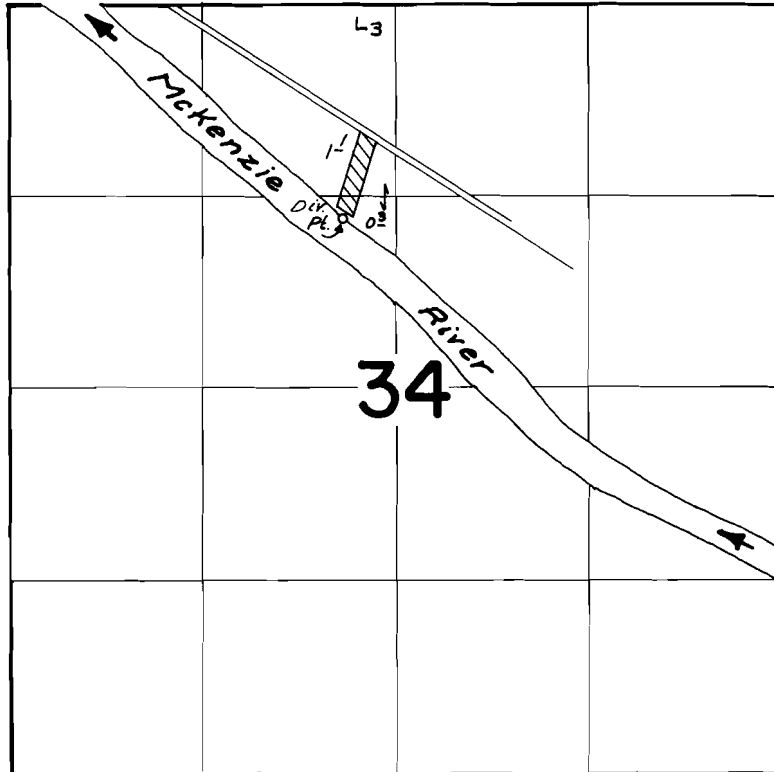

DIV. PT. LOC.: 1480' S. & 360' W. from N. 1/4 Cor. Sec. 34

FINAL PROOF SURVEY
UNDER

Application No. 50610 Permit No. 38245
IN NAME OF

Charles Donald & Frances Annette Croston

Surveyed May 27, 1976 by D.M. Norby