

T. 15S., R. 11W., W.M.

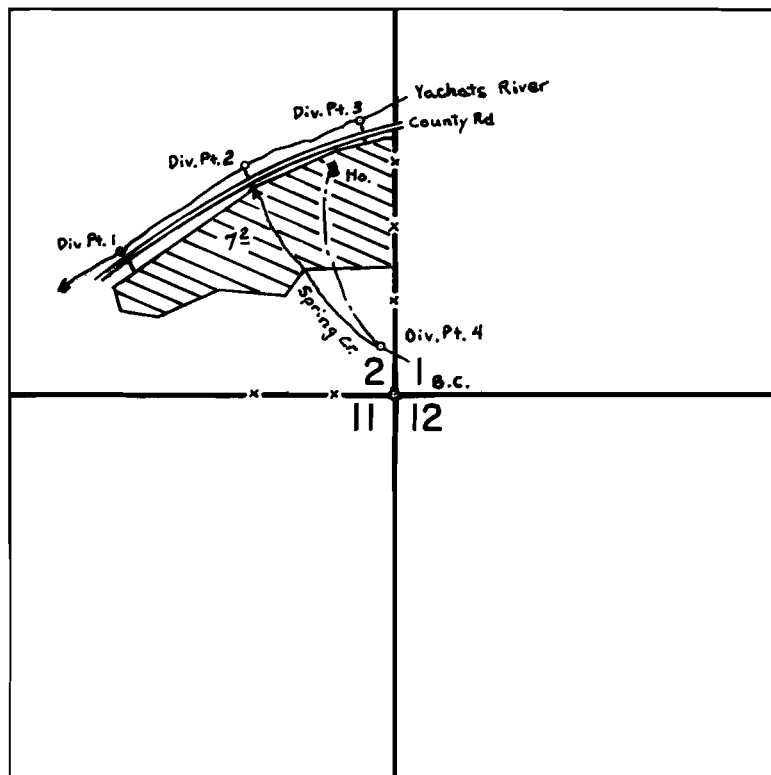

Div. Pts. Located: 1- 490' N., 940' W.; 2- 790' N., 510' W.; 3- 950' N., 125' W.; 4- 160' N., 50' W. from the S.E. cor. of Sec. 2

SCALE : 1" = 660'

FINAL PROOF SURVEY UNDER

Application No. 48603 Permit No. 36462
IN NAME OF

HARRAL G. & MABEL K. FIELD

Surveyed AUG. 11 1976, by D. NORBY