

Handwritten notes at the top of the page, partially illegible.

T.1 S., R.2 W., W.M.

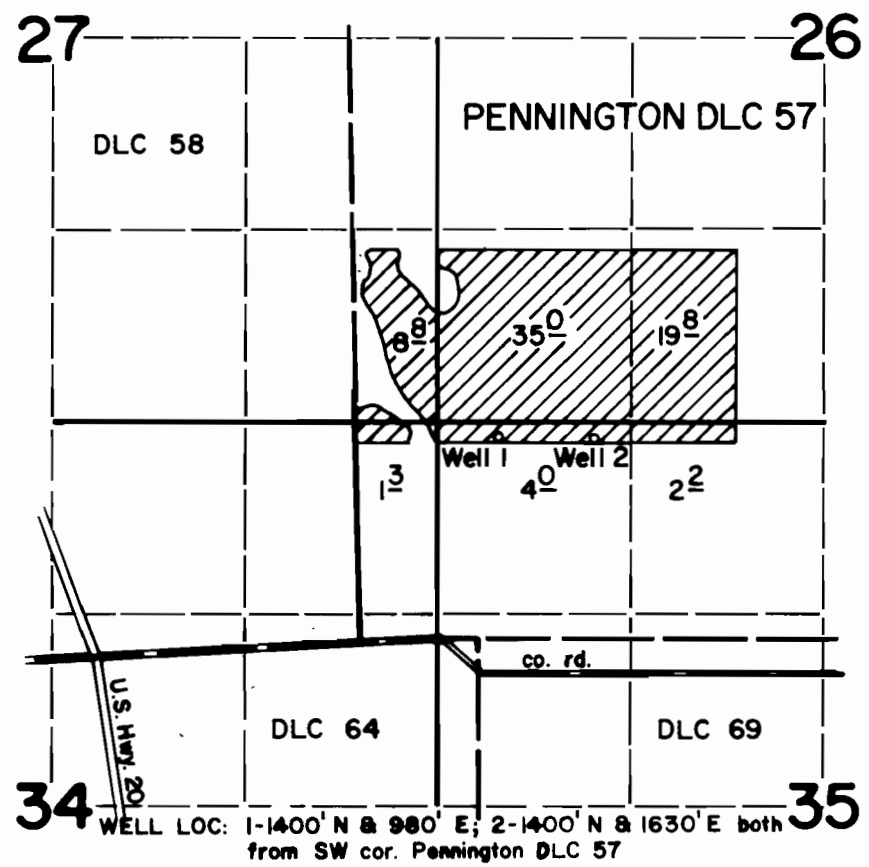

FINAL PROOF SURVEY UNDER

Application No. G-6042 Permit No. G-5719
IN NAME OF

LOUISE GLASSER SHEPHERD & DOROTHY MIER

Surveyed April 16 1976, by D. Norby