

T.10S., R.1W., W.M.

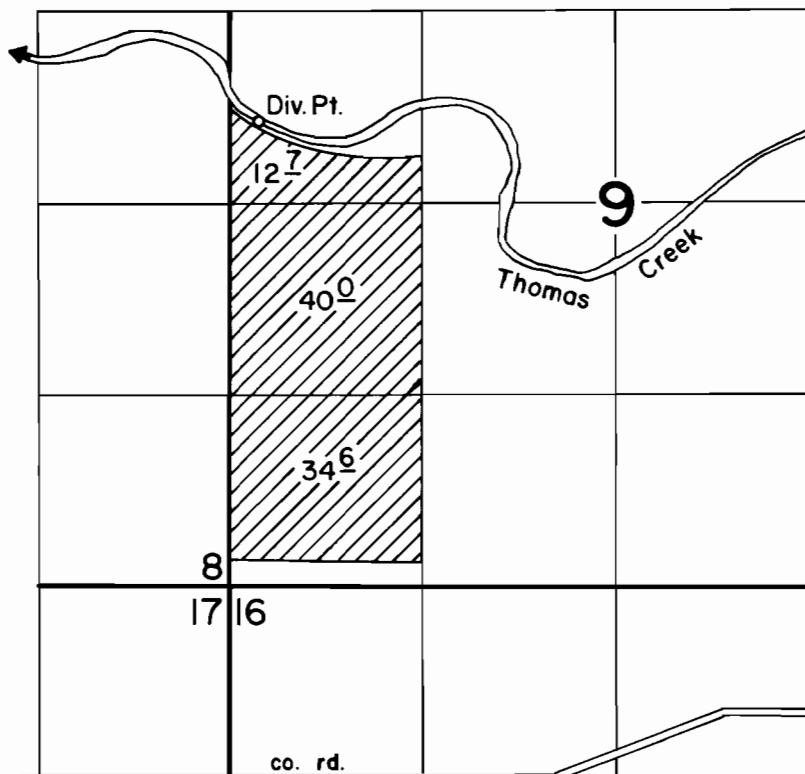

DIV. PT. LOC: 560' N & 200' E from W1/4 cor. sec. 9

FINAL PROOF SURVEY UNDER

Application No. 51967 Permit No. 39087
IN NAME OF

MARION FORKS INVESTMENT, INC.

Surveyed April 2 1976, by D. Norby