

T.5&6N.,R.35E.,W.M.

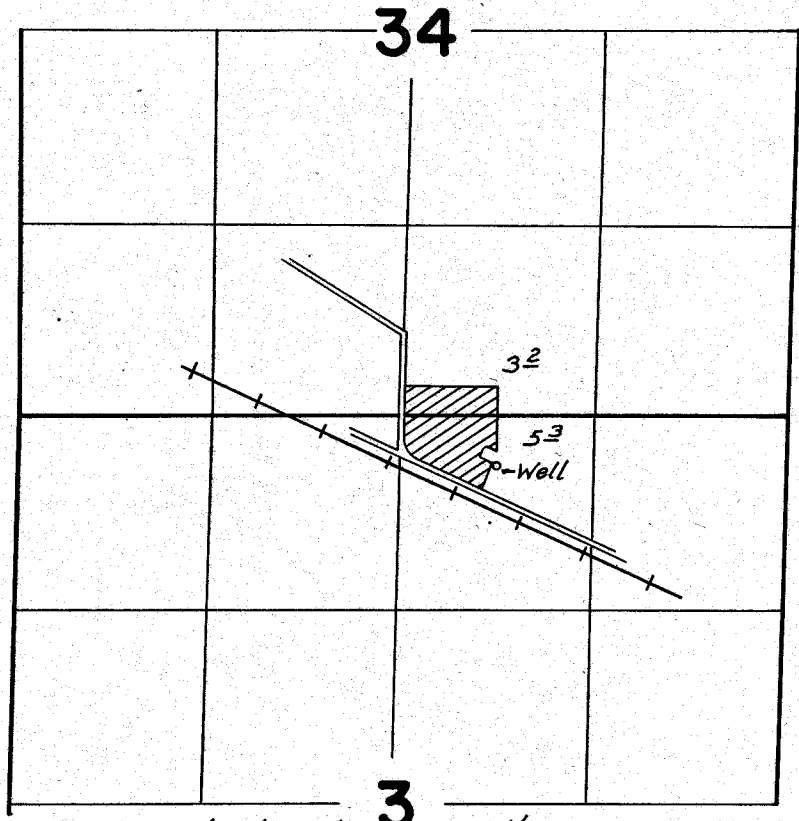

Well Loc.: 320'S., 660'E from N¹/₄ Cor. Sec. 3

FINAL PROOF SURVEY UNDER

Application No. G-6656 Permit No. G-6215
IN NAME OF
Cecil Carter

Surveyed Apr. 6, 1976, by C. R. King