

T.38S.,R.5W.,W.M.

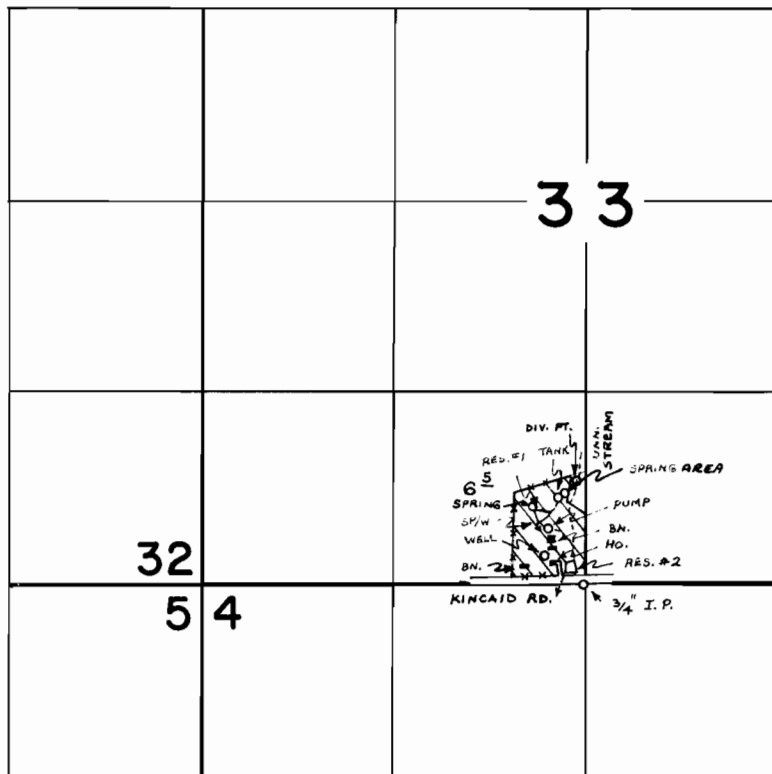

SPRING AREA: 620' N. & 130' W., RES. #1 DIV. PT. 480' N. & 300' W., RES. #2 DIV. PT. 130' N. & 75' W., & WELL 130' N. & 270' W., UNN. STREAM DIV. PT. 700' N. & 70' W., RES. #1 SPRING 520' N. & 360' W., ALL FROM S. 1/4 COR. SEC. 33.

FINAL PROOF SURVEY

UNDER

R-49223

R-5989

49224

36896

Application No. G-5630 Permit No. G-5462 SUPPL.
IN NAME OF

MARGARET ELIZABETH CHURCHILL

Surveyed NOV. 7 1977, by B. SUND