

39505

46410

**RECEIVED**  
JUN 11 1975  
STATE ENGINEER  
SALEM OREGON

T.34 S., R.7 E., W.M.

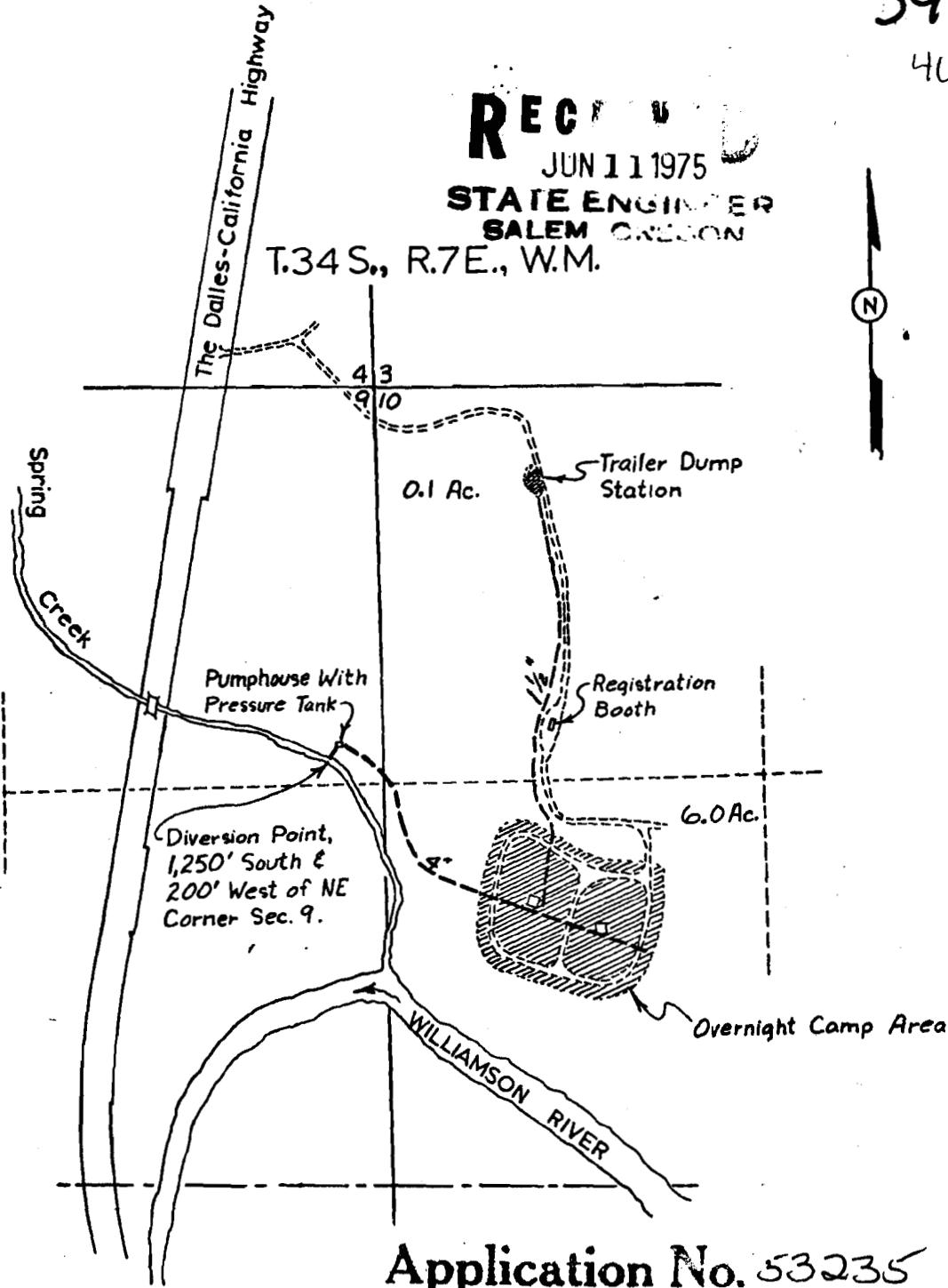

Spring Ck. Div. 55

Application No. 53235  
Permit No. 39505

Scale 0 600 1200 Feet

OREGON STATE HIGHWAY DIVISION  
PARKS & RECREATION BRANCH  
COLLIER MEMORIAL STATE PARK  
WATER RIGHT APPLICATION SEC. 9 & 10, T.34 S., R. 7 E., W.M.  
KLAMATH COUNTY JUNE 2, 1975