

T.15&16S. R.4W. W.M.

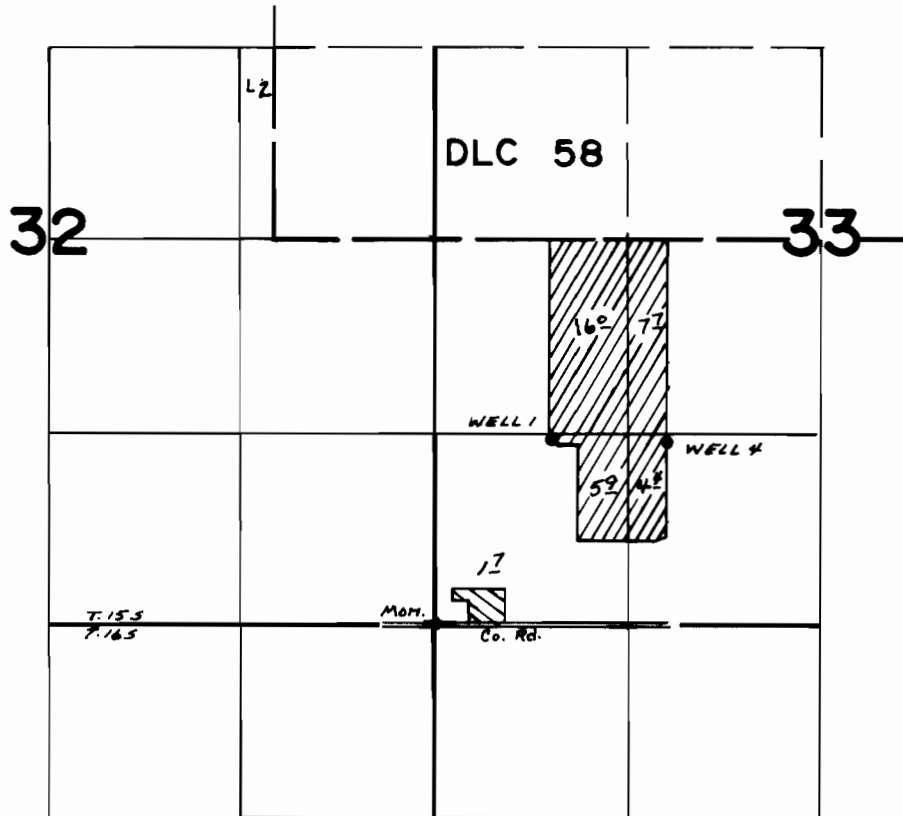

WELLS LOC.: 1-1260'N; 800'E; 4-1240'N; 1580'E FROM SW COR. SEC. 33

 - SUPPLEMENTAL WELL 4
 - PRIMARY WELL 1

FINAL PROOF SURVEY
UNDER

Application No. G-6104 Permit No. G-5782
IN NAME OF

ARTHUR G. JAGER

Surveyed MAY 10 1976, by D. NORBY