

T.18S.R.2W.W.M.

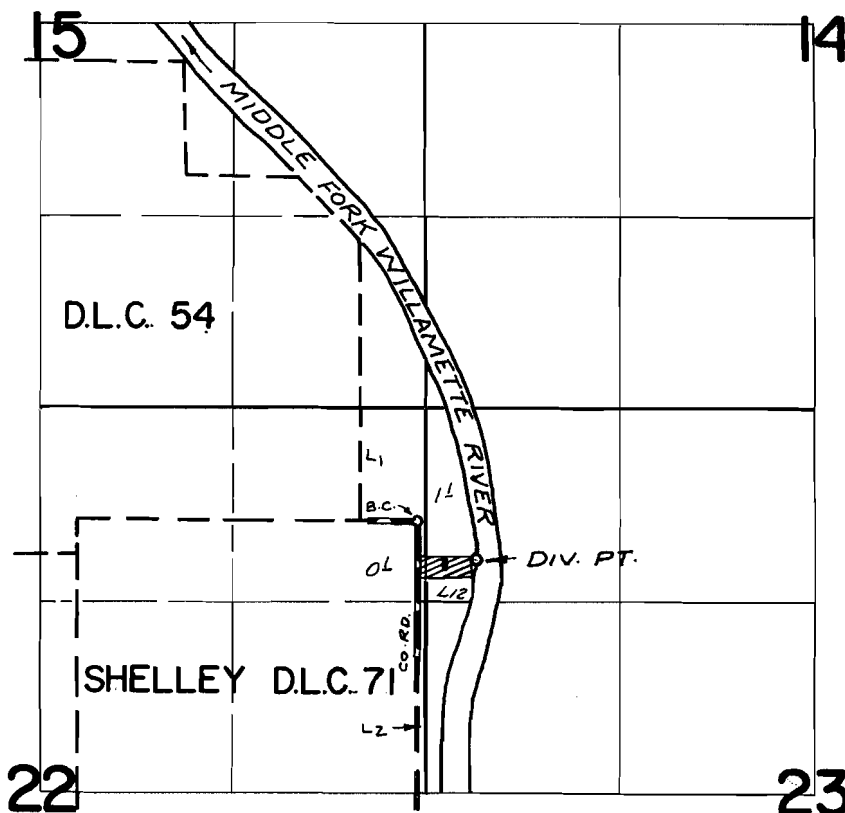

DIV. PT. LOC: 260'S. & 400'E. FROM N.E. COR. D.L.C. 71

FINAL PROOF SURVEY UNDER

Application No. 44673 Permit No. 33445
IN NAME OF

James W. Grant

Surveyed MAY 6, 1974, by R. MUCKEN