

# T. 17 S., R. 1 W., W. M.

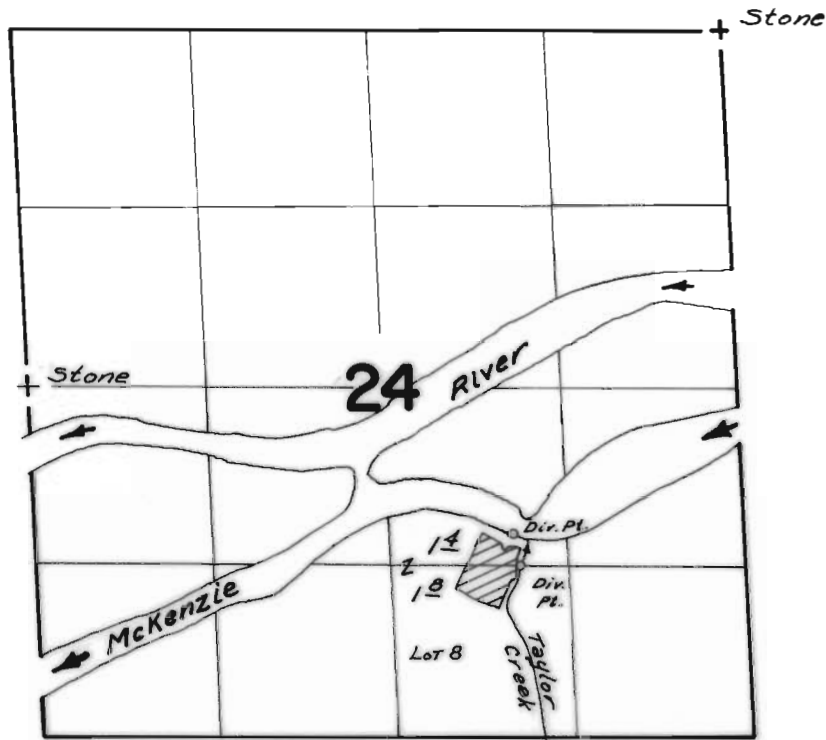

DIV. PTS. LOC.: #1 - 1170'S & 3280'E.; #2 - 1390'S & 3310'E.; both from W  $\frac{1}{4}$  Cor. Sec. 24.

## FINAL PROOF SURVEY UNDER

Application No. 47841 47842 Permit No. 35857 35858

IN NAME OF  
Hazen L. & Dorothy Olsen  
Frederic & Kathryn Edwards

Surveyed May 28, 1976, by D.M. Norby