

T. 15 S., R. 1 W., W.M.

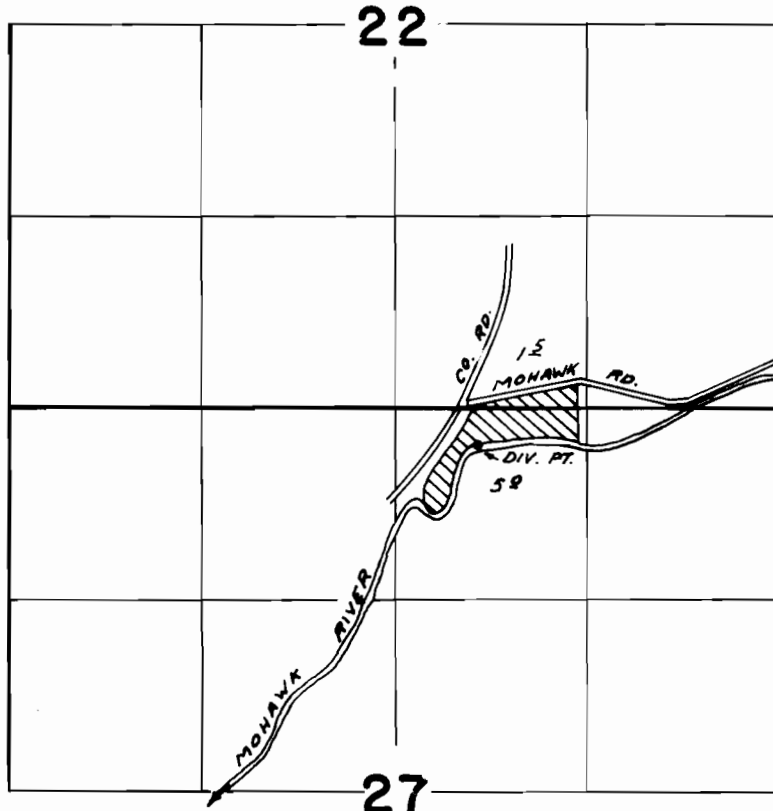

DIV. PT. LOC: 270' S. & 560' E. of N. 1/4 COR. SEC. 27

FINAL PROOF SURVEY UNDER

Application No. 49354 Permit No. 36998

IN NAME OF

John C. & Marion O'Leary

Surveyed Oct. 27, 1976, by D. M. Norby