

T.I.S., R.I.W., W.M.

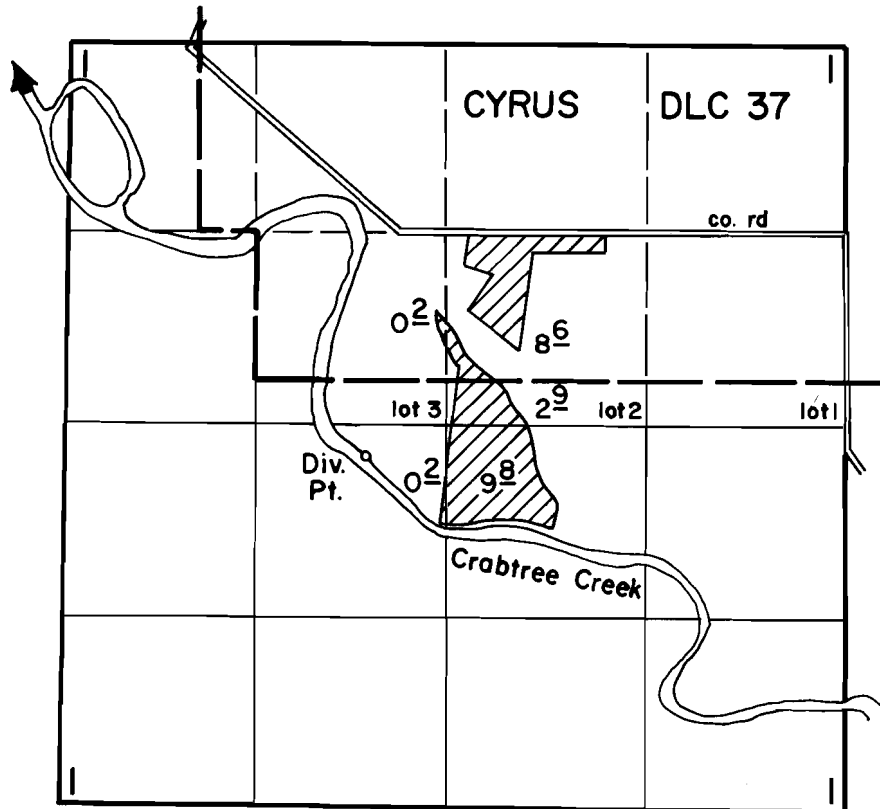

DIV. PT. LOC: 520' S & 760' E from s'y SW cor. Cyrus DLC 37

FINAL PROOF SURVEY UNDER

Application No. 50668 Permit No. 38278
IN NAME OF

BRUNO M. LUCKINI

Surveyed Mar. 30 1976, by D. Norby