

T.14S., R.1W., W.M.

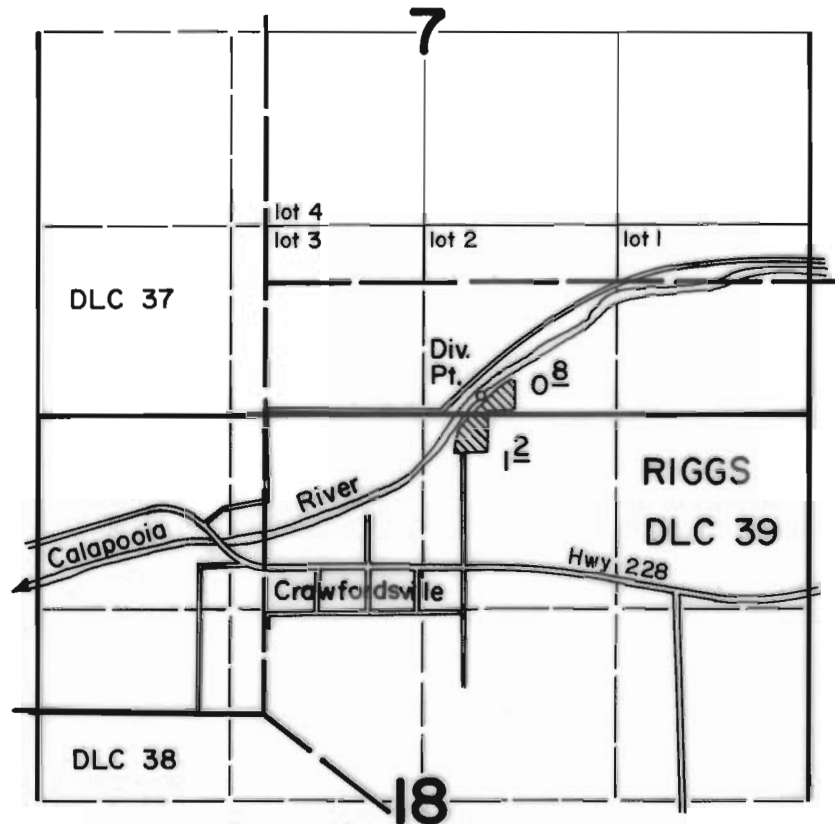

DIV. PT. LOC: 130' N & 390' E from S 1/4 cor. sec. 7

FINAL PROOF SURVEY
UNDER

Application No. 51701 Permit No. 37400
IN NAME OF

JAMES H. & CAROL M. McCracken

Surveyed May 5 1976, by D. Norby