

T.11S., R.2W., W.M.

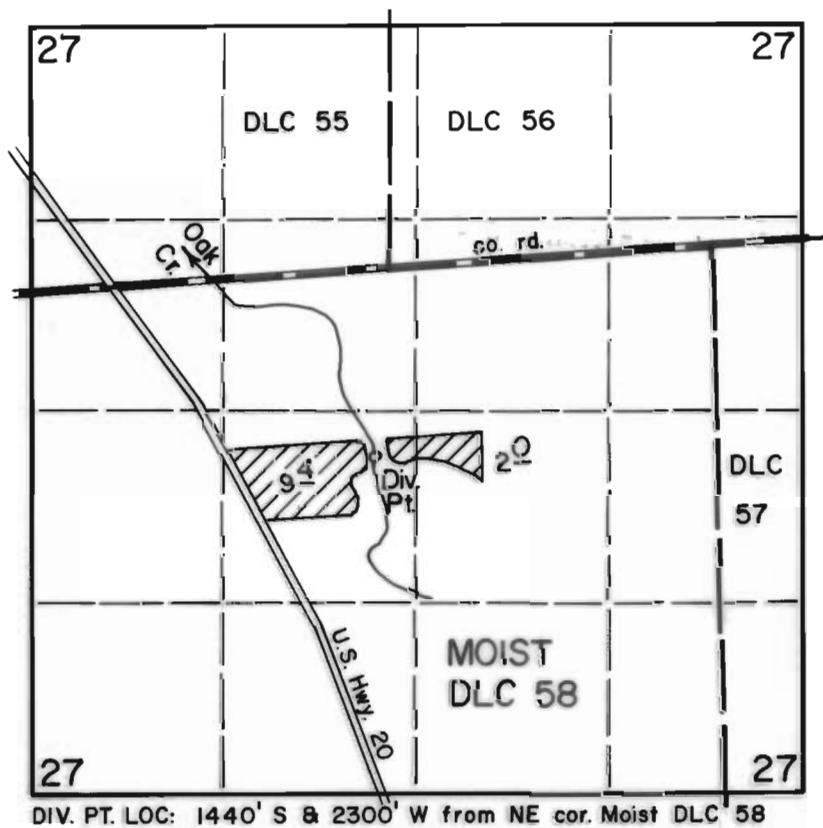

DIV. PT. LOC: 1440' S & 2300' W from NE cor. Moist DLC 58

FINAL PROOF SURVEY UNDER

Application No. 51763 Permit No. 39008
IN NAME OF

JOHN L. & THELMA L. SPIRES

Surveyed Sept. 7 1976, by D. Norby