

# T.8S.R.2W.W.M.

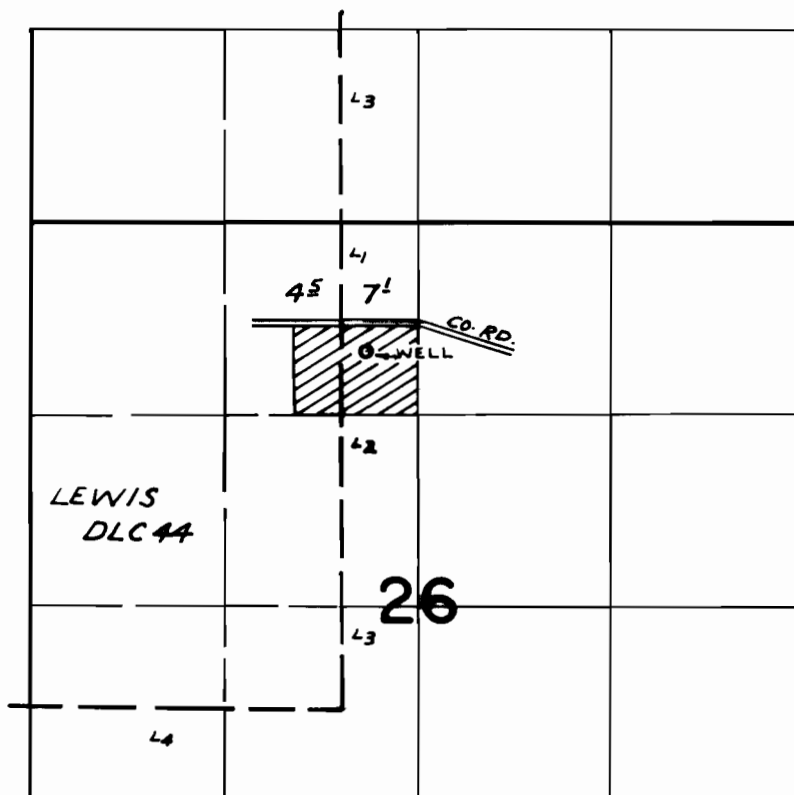

WELL LOC: 000'S. & 350' W. FROM N $\frac{1}{4}$  COR. SEC. 26

## FINAL PROOF SURVEY UNDER

Application No. *G-5973* Permit No. *G-5662*  
IN NAME OF

*HAROLD S. RADABAUGH*

Surveyed *AUG 4* 1976, by *R. MUCKEN*