

T.6S.,R.2W.,W.M.

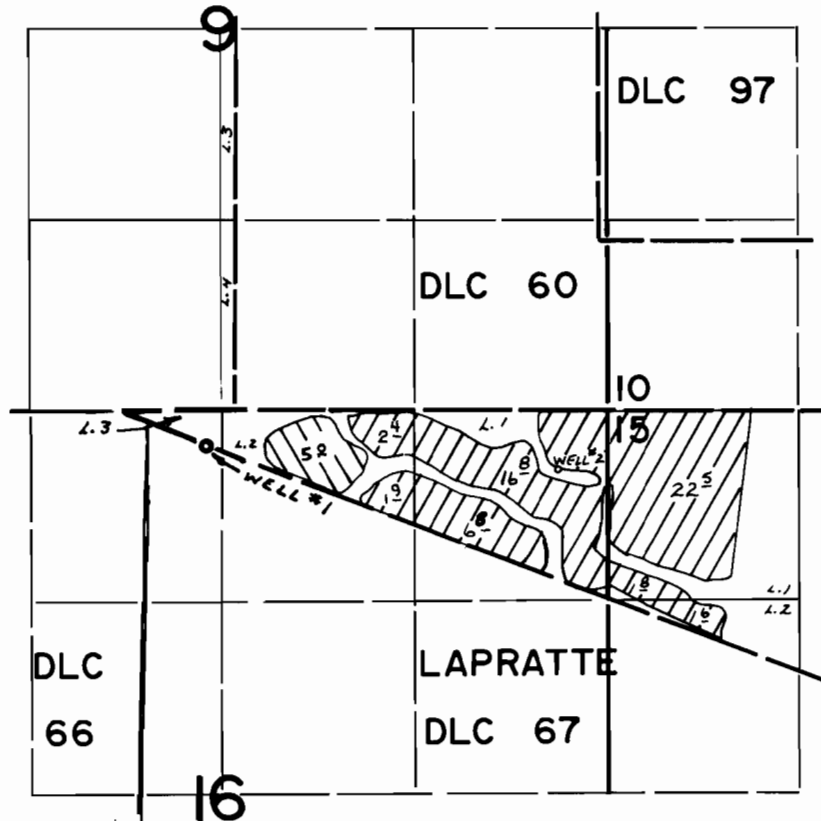

WELL #1 - 230' S AND 2760' W }  
WELL #2 - 400' S AND 340' W } BOTH FROM NE COR SEC 16

WELL #1  
WELL #2

**FINAL PROOF SURVEY**  
UNDER

Application No. G-6653 Permit No. G-6213  
IN NAME OF

JOHN L. EITEL

Surveyed MAY 17, 1976, by L. TOLL