

T.4S.,R.2W.,W.M.

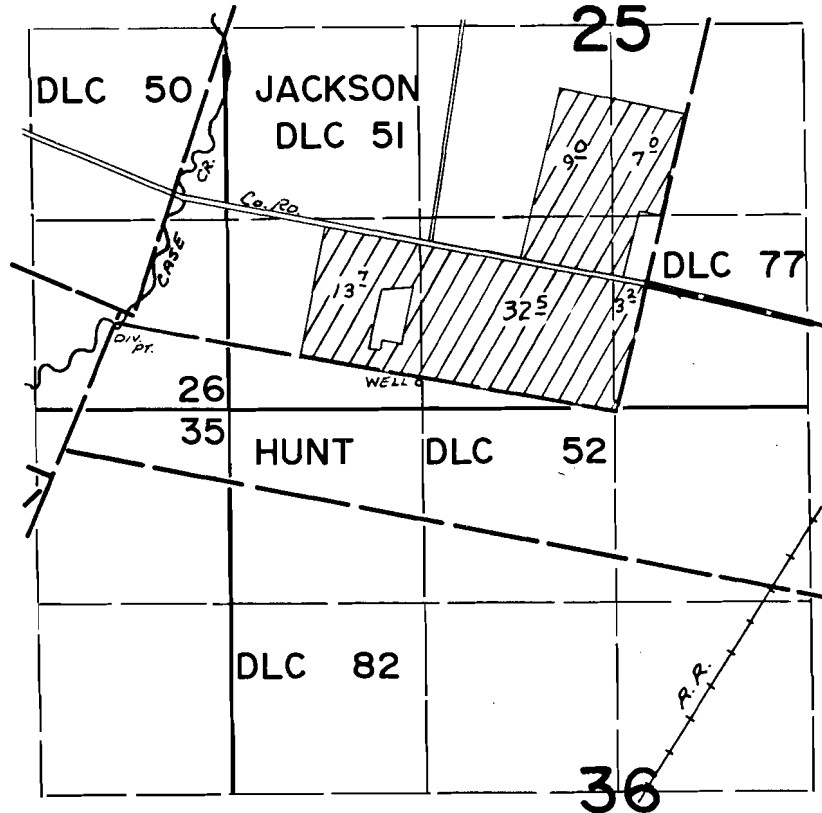

WELL (PRIMARY): 200' N AND 1370' W } BOTH FROM SE COR.
CASE (R. DIV. (SUPPL)): 590' N AND 3390' W } JACKSON DLC 51

FINAL PROOF SURVEY UNDER

G-5585 G-5443
Application No. 48515 Permit No. 36400.
IN NAME OF

RODERICK J. SONNEN

Surveyed APRIL 19, 1976, by L. TOLL